

iChair
XXL



SPARE PART LIST

iChair XXL
Model 1.614



MEYRA[®]
ORTOPEDIA
We move people.

iChair XXL / a

Table of contents

Introduction	5
Order specimen	6
01 Frame	
-Main frame	7
-Seat frame	8
03 Steering	
-Code 851; Operation for attendant (operating module interchangeable from front to back)	9
-Assembly parts for operating module	9
-Code 4566; Operating module bracket, height and length adjustable	10
-Code 4859; Operating module bracket length adjustable	10
-Code 4860; Operating module bracket, length and height adjustable, swivel-away	11
-Code 4789; Control for accompanying person	11
-Operating modules	12
-Code 4874; Protection rail for operating module	12
04 Drive	
-Drive	13
06 Chassis	
Steering wheels	
-Code 142; Steering wheel 260 x 70 (10")	14
Drive wheels	
-Code 460; Drive wheel ø356mm (14")	15
-Code 824-460; Splash guard for drive wheel – Wheel size 14"	16
07 Back support	
-Code 25; Electrically adjustable back support	17
-Code 401; Back support mechan. adj.	18
-Code 814; Horizontal pushing rod	18
Code 949; Back with shell (screwed version)	
-Code 4980; Incontinency cover black	19
-Code 254; Synth. leather, black	19
-Code 236; Graphite-grey-fabric	20
08 Seat	
-Code 27; electric seat height adjustment	21
-Code 27; electric seat height adjustment	21
-Code 118; Seat angle adjustment electric	22
-Code 119; Seat angle adjustment mechanical	22
Code 948; ErgoSeat-Seat	
-Code 4980; Incontinency cover black	23
-Code 254; Synth. leather, black	24
-Code 236; Graphite-grey-fabric	25
09 Arm support	
-Code 21; Arm supports, detachable, large, height adj., cushion	26
-Code 106; Arm support cushioned, removable, L, height adj.	27
-Code 4960; Adapter set for Hemi arm support pad	27
10 Leg supports	
-Bracket asmb. manual	28
-Bracket asmb. electric	28
-Code 86; Leg support electrically adj.	29
-Code 805; Foot plates plastic, divided	30
-Code 808; Foot plates angle adjustable	30
-Code 91; removable height adj. leg support, automatic length alignment, swivel-away (hexagon tube)	31
-Code 805; Foot plates plastic, divided	32
-Code 808; Foot plates angle adjustable	32
-Code 93; Removable leg supports, swivel-away	33
-Code 54; Footboard continuous (hexagon tube)	34
-Code 822; Shoe fastening strap	35
-Code 823; Heel support	35

15 Electrical system

-Code 115-702; Speed 6km/h – Electronic R-Net	36
-Code 117-702; Speed 10km/h – Electronic R-Net	36
-Code 932; Lighting for electronic wheelchair	37
-Code 678-702-932; Adjustment-lighting module-R-Net	37
-Contact allocation adjustment module	38

Batteries and chargers

-Drive batteries, sealed ~ 63Ah-5h/73Ah-20h	38
---	----

16 Working tables

-Code 702-813; Electronic R-Net – Table top operation, swivelling	39
-Therapy table for tabletop operation	40
-Code 415; Control panel with LED display	41
-Code 416; Control panel with LCD display	41
-Code 4646; Therapy table	42

24 Other Codes

-Code 590; Adj. splay wedge	43
-Code 676; Rear marking plate	43
-Code 833; Safety belt	44
-Code 906; additional rearview mirror (right)	44
-Code 927; Rearview mirror	45
-Code 913-949-254; Head support removable – Back support anatomically formed – Synth. leather black	45
-Code 954; Torso supports, swivel-away	46
-Code 957; Torso supports	46
-Code 970; Walking stick holder	47
-Code 994; Baggage rack	47

Accessories

-Accessories	48
--------------	----

iChair XXL / a Introduction

Exact specifications are required for your spare parts' orders. Only then we can guarantee that you will receive the correct spare part. All MEYRA-ORTOPEDIA -wheelchairs are manufactured according MEYRA-ORTOPEDIA -component group system.

Assembly group outline

Component unit 01: Frame	Component unit 12: Crossbrace
Component unit 03: Steering	Component unit 15: Electrical system
Component unit 04: Drive	Component unit 16: Working table
Component unit 05: Pressure Brake	Component unit 17: Support wheels
Component unit 06: Chassis	Component unit 20: Seat cushion
Component unit 07: Backrest	Component unit 24: Other Codes
Component unit 08: Seat	Component unit 26: Revetment
Component unit 09: Armrest	Component unit 98: Accessories and small parts
Component unit 10: Leg support	Component unit 99: Circuit diagrams

The index lists different versions of an assembly group, therefore you will find the spare part you are searching for quickly and precisely.

Note:

The assembly group outline also includes assemblies that do not apply to your model.

Liability/ guarantee for foreign products

Do not use any foreign products as spare parts or accessories for MEYRA-ORTOPEDIA -Wheelchairs. Foreign products may affect the operational reliability of the wheelchair, even if the foreign products have not been tested by TÜV or another official authority (General Type Approval). The scope of testing may not always be comprehensive enough. **MEYRA-ORTOPEDIA does not accept any liability or guarantee for foreign products used as spare parts or accessories as well as for damages and accidents caused by exchange or installation of such parts.**

Safety instructions for the use of spare parts

- When exchanging parts only use components corresponding to the wheelchair model and Code number.
- Please check after receipt if the spare part received is the same you ordered!
- Only authorized dealers or specialized workshops are allowed to carry out repairs on the wheelchair.
- Please take a test drive after repair of the wheelchair. Pay attention to unusual noises and check:
 - Braking ability
 - Steering ability
 - the straight running.

Abbreviations used

In the bills of material you will find following abbreviations:

AT means exchange components

The parts (articles or standard parts) marked with a letter can be reused after inspection!

Special features

Position numbers marked with a letter refer to parts not represented (e.g. for the opposite side).

Order specimen

To establish your order examples please proceed as follows.

1. **Type/Model**
Please take the type number from the instruction manual, the delivery note or the type plate.
2. **Manufacturing year and vehicle ID no.**
Read off the year of construction and the vehicle identification number from the type plate, e.g.:
Year of construction: 97/12
Vehicle ID No. (Fz-I-Nr.): 5678901
3. **Component unit**
Allocate the defective part to an assembly group (see assembly group outline).
4. **Code-No.:**
Compare the code numbers of delivery note with the Code list of the corresponding assembly group. Code-No.: 626 backrest height 30cm
5. **Look up representation of the assembly group chosen with corresponding Code No.**
The page where you can find the required representation and bills of material is indicated in the table of contents after the code number.
6. **Article-No:**
A position number is indicated on the spare part that is to be ordered enabling you to read off the corresponding article number from the bill of material.
7. **Determine the quantity**
Determine number of component units to be replaced.
Remark:
The number of pieces indicated in the bills of material correspond to the number of component units used in the assembly group (left and right wheelchair side).
8. **Determine the description**
Read off the corresponding designation from the bill of materials.
9. **Determine the colour**
Please take the colour code from the delivery note.
10. **Spare parts order:**
For a correct order please indicate all data.

Watch for the correct specifications on your order; Only then we can guarantee that you will receive the correct spare part.

Attention!

Subsequent changes to the wheelchair as well as arrangements with customers relating to the assembly group to be repaired have to be stated in your order.

Important information!

If any modifications have been made to the wheelchair, the specialized dealer is required to enclose the appropriate code no. as well as the date of the modifications, along with the operating instructions for the wheelchair. This ensures that no incorrect details will be given for future orders of spare parts. **Original- MEYRA-ORTOPEDIA - spare parts!**

iChair XXL / a
Component unit: Frame

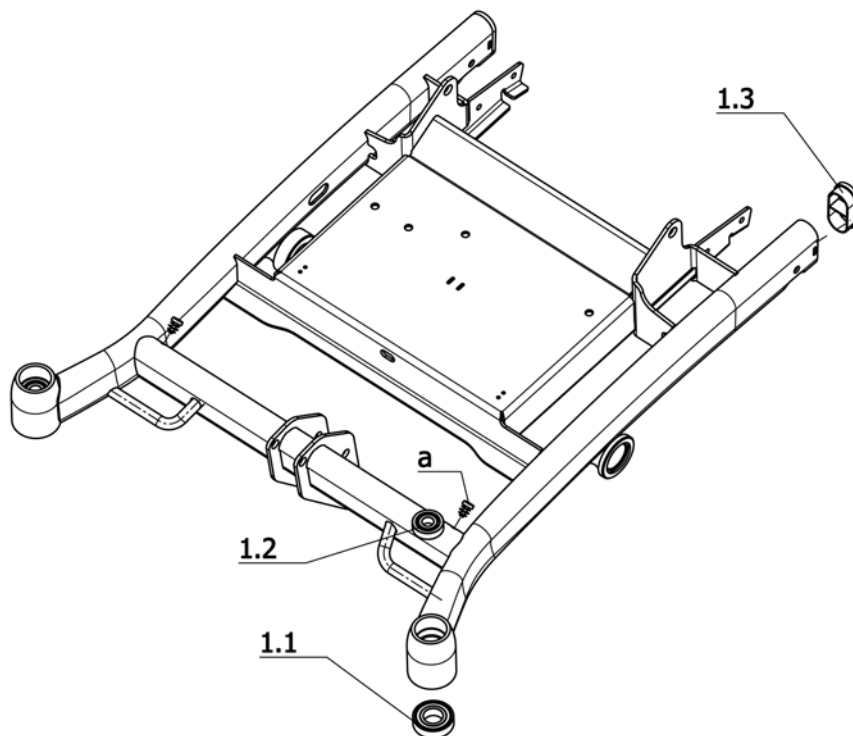

Sub Unit: Main frame

Item	Article-No:	Pc	Description
-	1 073 377	1	Frame asmb
1.1	206 502 800	2	Grooved ball bearing DIN 625 6004 2 RSR
1.2	206 503 200	2	Deep groove ball bearing, DIN 625,6201-2Z
1.3	205 032 000	2	Plastic slider FL 60x30x2
a	8 415 117	2	lamella plug, black for tube 12 mm

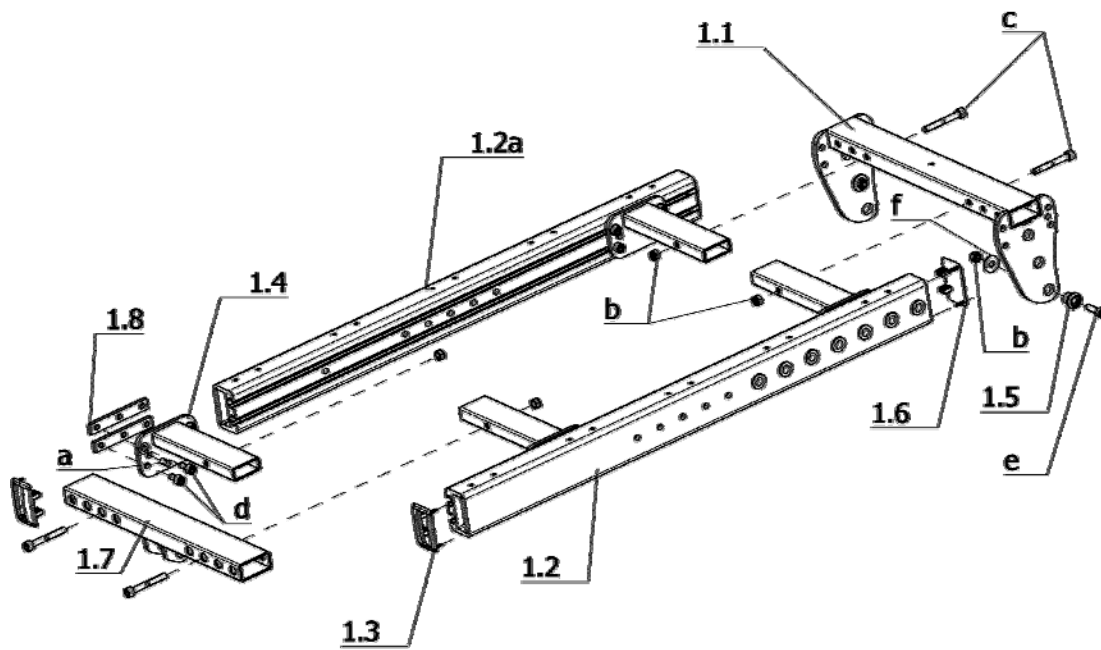

Sub Unit: Seat frame

Item	Article-No:	Pc	Description
1.1	1 073 385	1	Rear seat link
1.2	1 073 393	1	Seat frame tube left
1.2a	1 073 394	1	Seat frame tube right
1.3	1 067 266	2	Plastic cap front (with pass hole)
1.4	1 073 388	4	Seat adjustment tube
1.5	1 069 772	2	Link bushing
1.6	1 067 265	2	Plastic cap rear
1.7	1 073 390	1	Front seat link
1.8	1 069 799	8	Clamping piece 75x12x4 with 3x M6
a	207 902 500	4	Close tolerance grooved pin 6 x 12 ST A2K 8435008
b	207 320 100	6	Locknut, DIN 980/8, M6, A3T
c	207 302 800	4	Cheese head screw M6x45 DIN912
d	207 122 300	16	Cheese head screw DIN 912 M6x12 -8.8
e	207 121 500	2	Cheese head screw DIN 912 M6x20
f	207 335 100	2	Washer DIN 9021-B6,4 ST A3T

Sub Unit: Seat frame

Item	Article-No:	Pc	Description
-			Code 48; Seat width 48cm
-	1 073 380	1	Seat frame asmb. SW 48 cm
-			Code 53; Seat width 53cm
-	1 073 381	1	Seat frame asmb. SW 53 cm
-			Code 358; Seat width 58 cm
-	1 073 382	1	Seat frame asmb. SW 58 cm

iChair XXL / a
Component unit: Steering

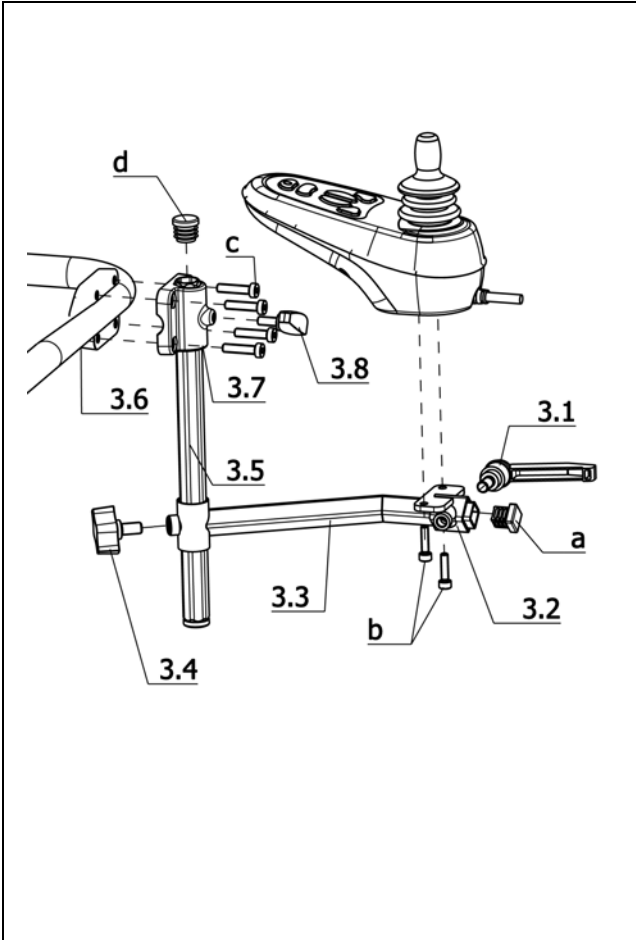

Sub Unit: Code 851; Operation for attendant (operating module interchangeable from front to back)

Item	Article-No:	Pc	Description
-	1 072 650	1	Operating module br. Code 851 for attendant repositionable
3.1	206 656 600	1	Tilt-clamping lever M 8 x 15
3.2	1 072 645	1	Receptacle
3.3	1 072 647	1	Rear receptacle
3.4	205 113 800	1	Wing screw M8x15
3.5	1 072 649	1	Push bar
3.6	1 059 665	1	Head support clamp (without receptacle)
3.7	1 059 664	1	Head support bracket (incl. hex. socket receptacle)
3.8	205 114 800	1	WING SCREW M 6 X 15
a	205 006 000	1	Plastic slide, 15/15/1,5-2
b	207 123 000	2	Cheese head screw,DIN 912 M5x20 8.8 A3K VC3 coated
c	207 352 100	4	CYLINDER SCREW DIN7984 M 6 X 25 8.8 A3T
d	205 027 100	2	Plastic slide GL 18 black

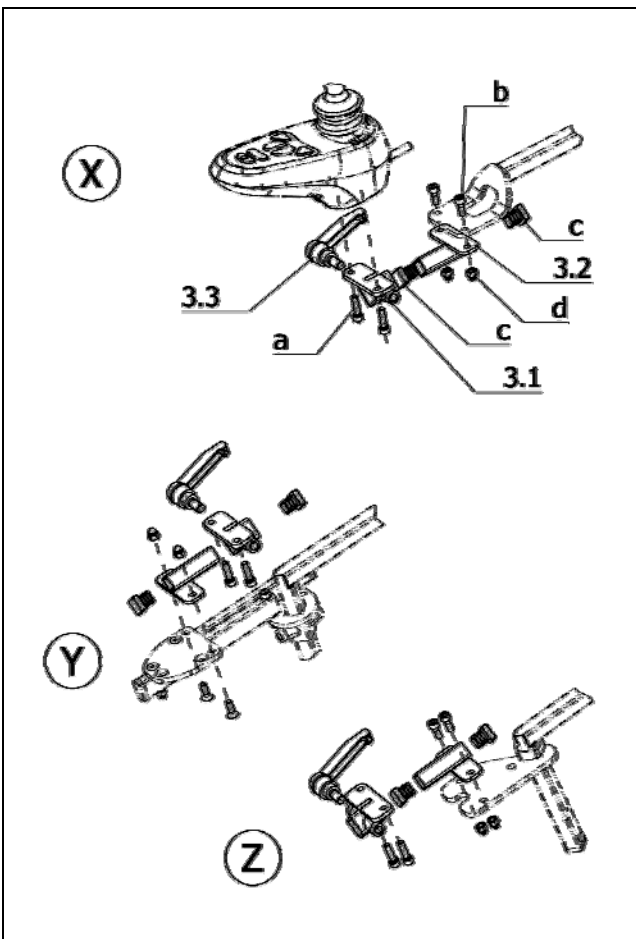

Sub Unit: Assembly parts for operating module

Item	Article-No:	Pc	Description
3.1	1 072 645	1	Receptacle
3.2	1 072 643	1	Front receptacle
3.3	206 656 600	1	Tilt-clamping lever M 8 x 15
a	207 123 000	1	Cheese head screw,DIN 912 M5x20 8.8 A3K VC3 coated
b	207 192 500	2	CYLINDER SCREW M 5 X 14 8.8 034165*
c	205 006 000	2	Plastic slide, 15/15/1,5-2
d	207 324 000	2	Locking cap nut,DIN 986,M5
X	0	0	Code 4859; Operating module bracket length adjustable
Y	0	0	Code 4566; Operating module bracket, height and length adjustable
Z	0	0	Code 4860; Operating module bracket, length and height adjustable, swivel-away
a	207 123 000	2	Cheese head screw,DIN 912 M5x20 8.8 A3K VC3 coated
b	207 633 400	2	Countersunk head screw DIN 7991 M6x16

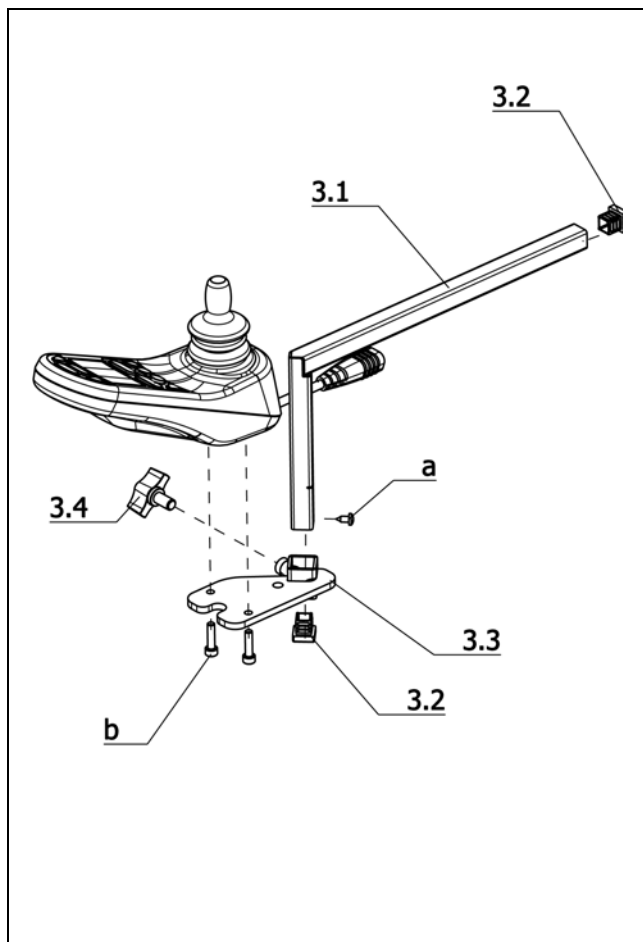
**Sub Unit: Code 4566; Operating module bracket, height and length adjustable**

Item	Article-No:	Pc	Description
3	1 070 781	1	Operating module br. Code 4566 height, length adjustable
3.1	1 070 770	1	Push bar
3.2	205 006 000	2	Plastic slide, 15/15/1,5-2
3.3	1 070 780	1	Receptacle
3.4	205 113 800	2	Wing screw M8x15
a	207 318 100	1	Filister head tapping screw, DIN 7981 B4,2x9,5 St.
b	207 123 000	3	Cheese head screw,DIN 912 M5x20 8.8 A3K VC3 coated

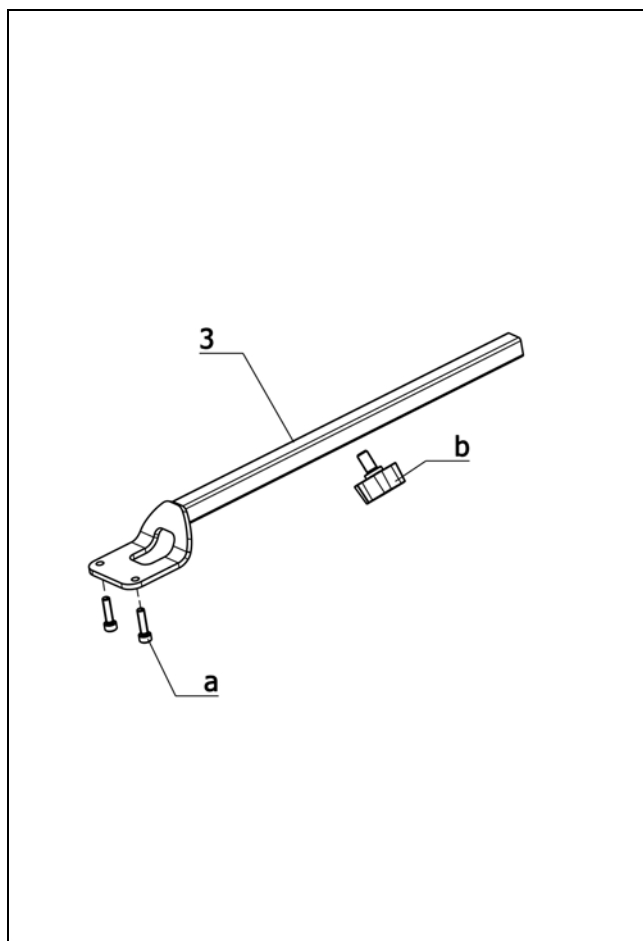
**Sub Unit: Code 4859; Operating module bracket length adjustable**

Item	Article-No:	Pc	Description
-	1 070 766	1	Operating mod. bracket asmb. Code 4859 length adjustable
3	1 070 765	1	Operating module bracket
a	207 123 000	2	Cheese head screw,DIN 912 M5x20 8.8 A3K VC3 coated
b	205 113 800	1	Wing screw M8x15

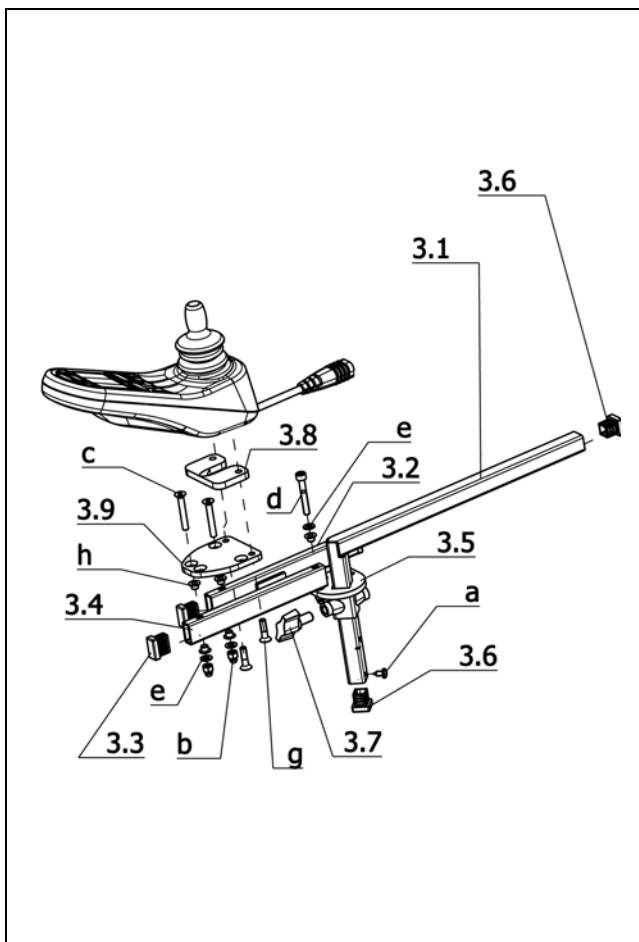
iChair XXL / a
Component unit: Steering

Sub Unit: Code 4860; Operating module bracket, length and height adjustable, swivel-away

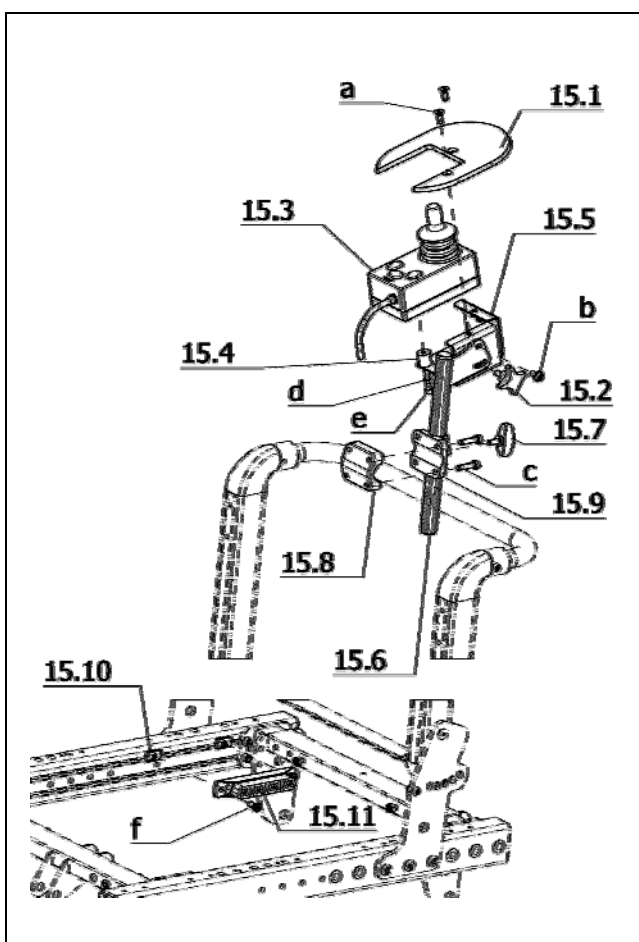
Item	Article-No:	Pc	Description
3	1 070 772	1	Operating module br. Code 4860 asmb.(note Code 60/74)
3.1	1 070 770	1	Push bar
3.2	1 070 776	1	Pivot arm cpl
3.3	205 047 900	3	Plastic slide,black,20x10 NO.6202010
3.4	1 063 948	1	Swivel arm
3.5	1 070 774	1	Receptacle
3.6	205 006 000	2	Plastic slide, 15/15/1,5-2
3.7	205 113 800	2	Wing screw M8x15
3.8	1 070 768	1	Underliner 6mm
3.9	1 070 767	1	Adapter plate
a	207 318 100	1	Filister head tapping screw, DIN 7981 B4,2x9,5 St.
b	207 324 000	4	Locking cap nut, DIN 986, M5
c	207 019 000	2	Flat head screw M5 X 35 DIN-EN-ISO-10642 8.8 A3T
d	207 192 700	3	Cheese head screw, DIN 912
e	207 330 100	4	Washer DIN 125-B5, 3 St A3T
g	207 137 300	2	countersunk screw with hexagon M 5 X 20 10.9 A2R 8013656
h	206 557 300	8	Friction bearing form F

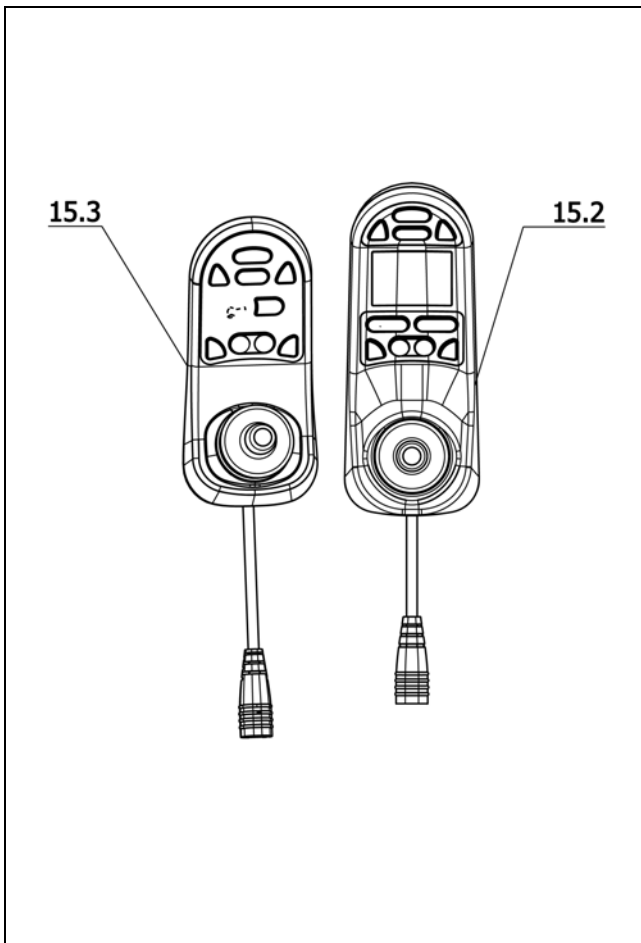

Sub Unit: Code 4789; Control for accompanying person

Item	Article-No:	Pc	Description
-	1 070 796	1	Operating module br. Code 4789 e Oper. module R-NET(Code 702)
15.3	206 905 700	1	Operating module for attendant R-NET electronic for Code 4789
15.1	8 461 574	1	SUPPORT PLATE FOR DSB- ATTANDANT
15.2	8 438 432	1	cross grip screw, black M 6 X 15 with point AD=40
15.4	8 108 509	1	DISTANCER SLEEVE F.OPER.MODULE BPS 21 AVANTAGE
15.5	8 104 884	1	ANGLE PLATE WITH NUTS FOR ADD. ATTENDANT CONTROL
15.6	1 070 793	1	Adjustment tube
-	205 027 100	1	Plastic slide GL 18 black
15.7	205 114 800	1	WING SCREW M 6 X 15
15.8	1 059 665	1	Head support clamp (without receptacle)
15.9	1 059 664	3	Head support bracket (incl. hex. socket receptacle)
15.10	1 002 850	2	Clamping piece
15.11	206 907 200	1	BUS-plug 4-fold for R-NET (4-fold connection plug board)
a	207 633 400	2	Countersunk head screw DIN 7991 M6x16
-	207 322 000	2	Locknut, DIN 980/8, M5
b	209 005 400	1	Filister flat head screw, M6x12
c	207 352 100	4	CYLINDER SCREW DIN7984 M 6 X 25 8.8 A3T
d	207 429 300	2	Locking washer S5
e	207 303 500	4	Cheese head screw DIN 912 M5x30
f	207 350 200	2	Cheese head screw, M 6x12-8.8 A3T DIN6912
-	206 907 700	1	BUS-cable 0.5m (R-NET)

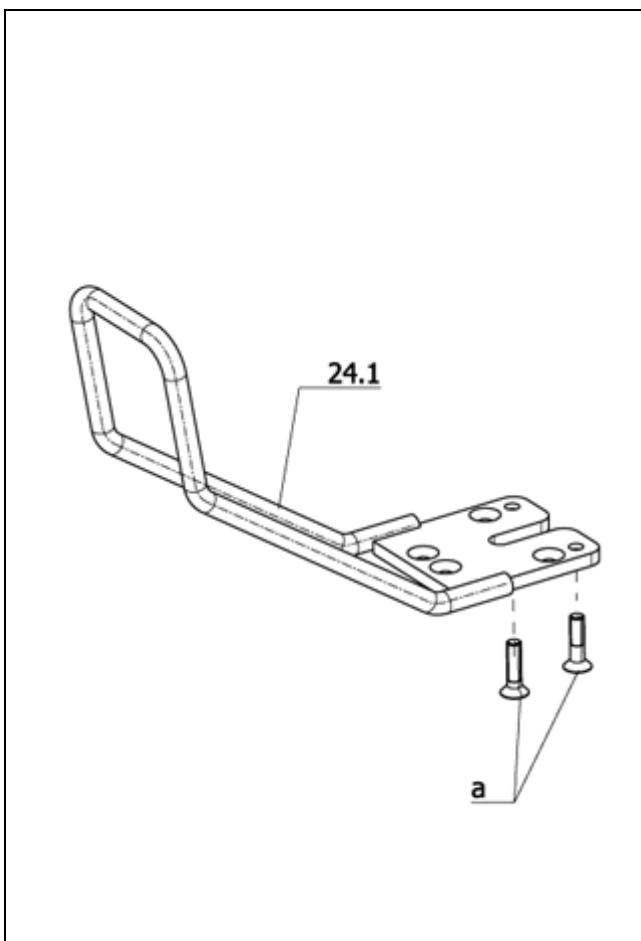

Sub Unit: Operating modules

Item	Article-No:	Pc	Description
15.3	206 849 700	1	Oper.module standard display R-NET code 415-702
-	426 849 700	1	Exc.-oper.module stand display R-NET code 415-702
15.2	206 849 900	1	Oper.module colour display R-NET code 416-702
-	426 849 900	1	Exc.-oper.module col. display R-NET code 416-702



Sub Unit: Code 4874; Protection rail for operating module

Item	Article-No:	Pc	Description
-	1 070 778	1	Protection lever asmb.Cd. 4874 (refit kit w screws)
24.1	1 070 783	1	Protection bracket
a	207 137 300	2	countersunk screw with hexagon M 5 X 20 10.9 A2R 8013656

iChair XXL / a
Component unit: Drive

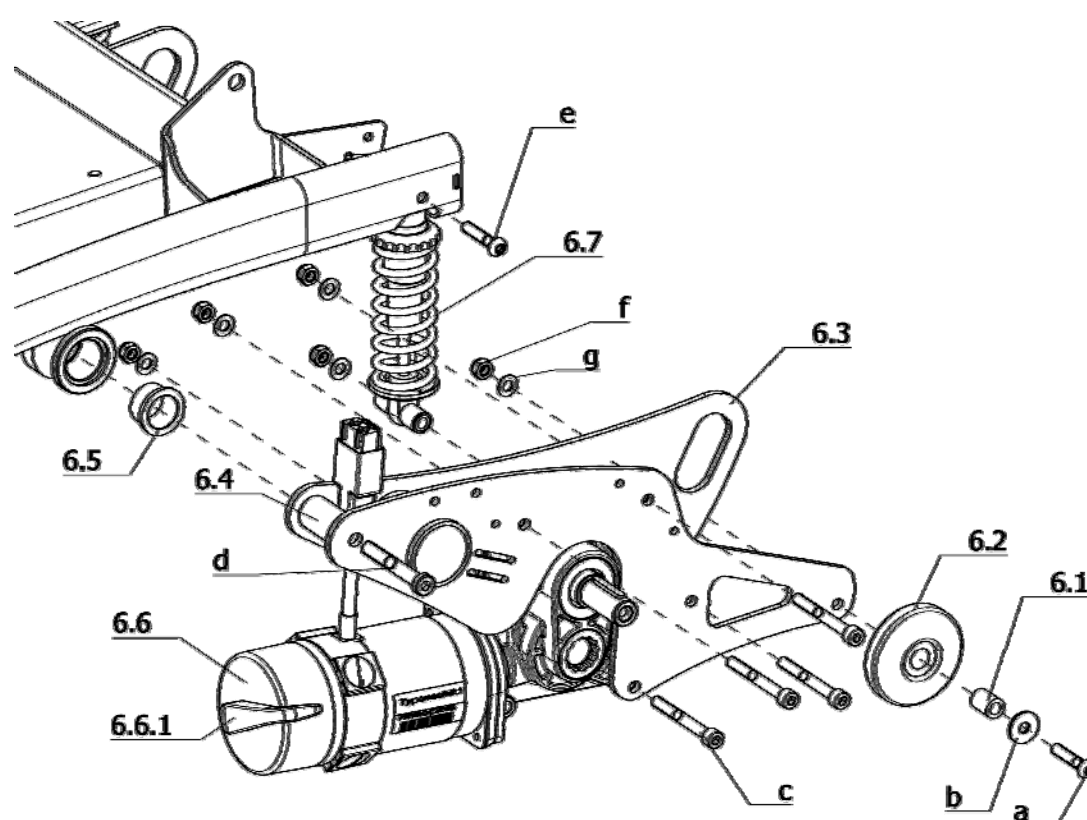

Sub Unit: Drive

Item	Article-No:	Pc	Description
6.1	1 063 985	2	Flange sleeve
6.2	206 271 706	2	DEFLECTOR ROLL D=75 BLACK RAL 9005
6.3	1 073 362	1	Left drive rocker
6.3a	1 073 363	1	Right drive rocker
6.4	1 069 769	2	Rocker axle
6.5	206 554 900	4	FLANGE SLEEVE NO.5069
6.6.1	5 006 659	2	Brake handle with gasket
-	1 071 200	2	Brake handle (motor disengage)
-	206 606 400	2	Gasket (for AMT with 1071200)
a	207 381 000	2	Filister head screw ISO 7380 M8x40-10.9 A3T
b	207 335 000	2	Washer DIN 9021, B 8.4
c	207 194 100	8	Cheese head screw M8X70 DIN 912 8.8 A3T
d	207 597 900	2	Cheese head screw M10x70 DIN984 - 8.8 A3T
e	207 381 000	2	Filister head screw ISO 7380 M8x40-10.9 A3T
f	207 320 200	12	Locknut DIN 985 M8-8 A3T
g	207 330 300	12	Washer DIN 125 - B8,4 ST A3T
-	206 923 600	1	Carbon brush set 1x per motor for 1.595/1.614 (4 pieces) AMT

Sub Unit: Drive

Item	Article-No:	Pc	Description
			Code 115; Speed 6km
6.6	1 071 230	1	Drive left "300W; 2750U/min; I=28.7/1 AMT
6.6	401 071 230	1	Exch.-drive left "300W; 2750U/min; I=28.7/1 AMT
6.6a	1 071 231	1	Drive right "300W; 2750U/min; I=28.7/1 AMT
6.6a	401 071 231	1	Exch.-drive right "300W; 2750U/min; I=28.7/1 AMT
			Code 117; Speed 10km
6.6	1 073 802	1	Drive left "350W; 4300U/min; I=28.7/1 AMT
6.6	401 073 802	1	Exch.-drive left "350W; 4300U/min; I=28.7/1 AMT
6.6a	1 073 803	1	Drive right "350W; 4300U/min; I=28.7/1 AMT
6.6a	401 073 803	1	Exch.-drive right "350W; 4300U/min; I=28.7/1 AMT
			Code 893; User weight up to 200kg
6.7	206 309 700	2	Damper R=20 N/mm "L=175mm

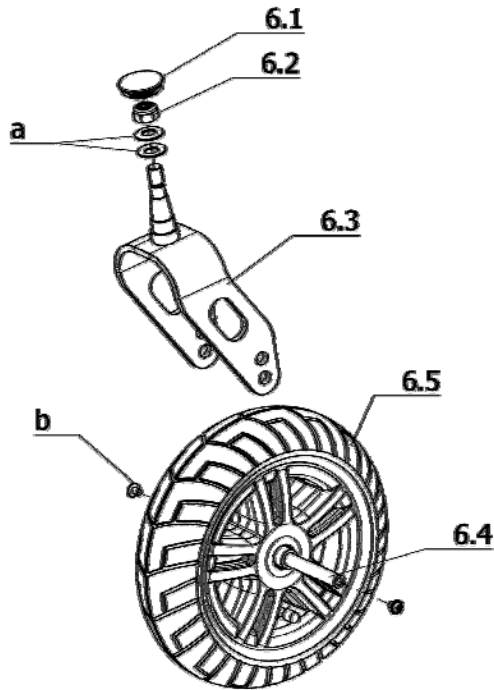

Sub Unit: Code 142; Steering wheel 260 x 70 (10")

Item	Article-No:	Pc	Description
6.1	205 204 406	2	Cap
6.2	207 322 200	2	Locknut DIN 980/8 M12x1,5-5 A3T
6.3	1 070 851	2	Steering fork for 9" and 10" Steering wheel
6.4	1 069 366	2	Axle L=91mm D=11.9mm (2xM8)
a	206 340 100	4	Cup spring A 25 DIN 2093 ST
b	207 018 700	4	Filister head screw M 8 x 12 10.9 AZR POLY-LOK
Code 146-908; Puncture protected tyres for steering wheels – Tyres black			
6	1 070 854	1	Steering wheel left asmb. 10" Code 142-146-908
6.5	1 070 846	1	Steering wheel left 10" Code 142-146-908
6a	1 070 855	1	Steering wheel right asmb.10" Code 142-146-908
6.5a	1 070 847	1	Steering wheel right 10" Code 142-146-908
-	206 126 500	2	Tube 3.00-6 for 10"
-	206 126 800	2	"Casing 3.00-6 for 10" black" (puncture protected)
Code 146-909; Puncture protected tyres for steering wheels – Tyres grey			
6	1 070 852	1	Steering wheel left asmb. 10" Code 142-146-909
6.5	1 069 121	1	Steering wheel left 10" Code 142-146-909
6a	1 070 853	1	Steering wheel right asmb.10" Code 142-146-909
6.5a	1 070 845	1	Steering wheel right 10" Code 142-146-909
-	206 126 500	2	Tube 3.00-6 for 10"
-	206 126 400	2	Tyre 3.00-6 for 10" grey

Sub Unit: Code 142; Steering wheel 260 x 70 (10")

Item	Article-No:	Pc	Description
Code 900-908; Puncture proof tyres for steering wheels – Tyres black			
6	1 070 859	1	Steering wheel left asmb. 10" Code 142-900-908
6.5	1 070 849	1	Steering wheel left 10" Code 142-900-908
6a	1 070 860	1	Steering wheel right asmb.10" Code 142-900-908
6.5	1 070 850	1	Steering wheel right 10" Code 142-900-908
Code 900-909; Puncture proof tyres for steering wheels – Tyres grey			
6	1 070 857	1	Steering wheel left asmb. 10" Code 142-900-909
6.5	1 069 122	1	Steering wheel left 10" Code 142-900-909
6a	1 070 858	1	Steering wheel right asmb.10" Code 142-900-909
6.5a	1 070 848	1	Steering wheel right 10" Code 142-900-909

iChair XXL / a
Component unit: Chassis

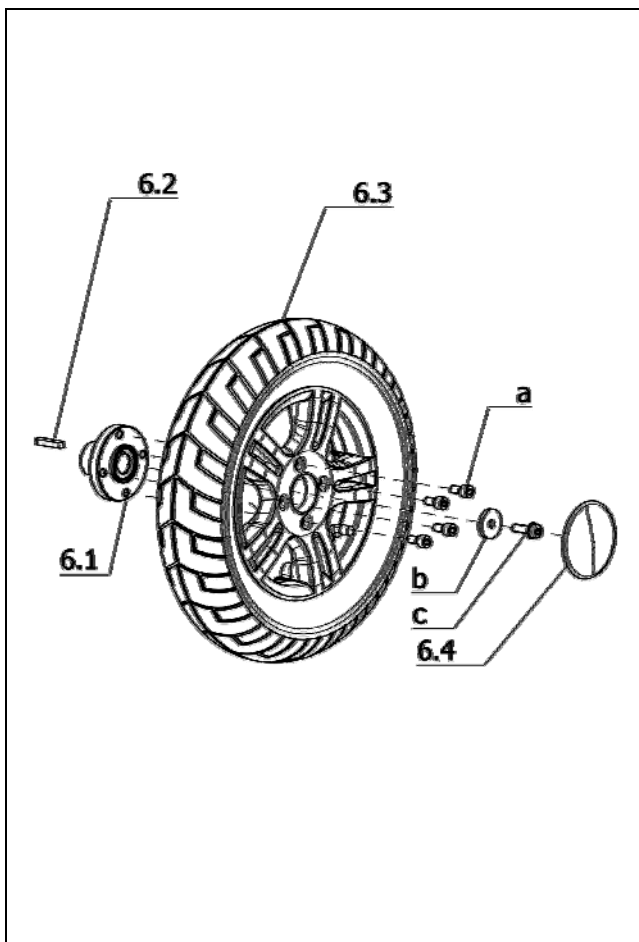

Sub Unit: Code 460; Drive wheel ø356mm (14")

Item	Article-No:	Pc	Description
6.1	1 069 130	2	Tappet hub for drive wheel 14"
6.2	207 055 900	2	Spring key DIN 6995 A6x6x36St
6.4	1 070 478	2	Cover cap drive wheel 12" 14" AL-rim"
a	207 303 800	8	Cheese head screw, DIN 912, M 8x20-8.8, VC3 coated ->Tighten screw with 30Nm during assembly.
b	1 054 958	2	WASHER
c	205 598 000	2	Hexagon screw M8x25 VERBUSRIPP
Code 482-909; Standardluftbereifung (Stollenprofil) – Bereifung grau			
6.3	1 074 585	2	"Drive wheel 14" cleat profil pneumatic Code 460-482-909
-	206 129 600	2	"Casing 3.00-8 grey for 14" cleat profile 0334
-	206 127 400	2	Tube 3.00-8 for 14"
Code 846-909; Puncture protected tyres for drive wheels – Tyres grey			
6.3	1 069 126	1	Drive wheel right 14" Code 460-846-909
6.3a	1 069 125	1	Drive wheel left 14" Code 460-846-909
-	206 127 900	2	Tyre "3.00-8 for 14" grey"
-	206 127 400	2	Tube 3.00-8 for 14"
Code 846-908; Puncture protected tyres for drive wheels – Tyres black			
6.3	1 070 479	1	Drive wheel left 14" Code 460-846-908
6.3a	1 070 840	1	Drive wheel right 14" Code 460-846-908
-	206 127 500	2	Tyre 3.00-8 for 14" black
-	206 127 400	2	Tube 3.00-8 for 14"

Sub Unit: Code 460; Drive wheel ø356mm (14")

Item	Article-No:	Pc	Description
Code 904-908; Puncture safe tyres – Tyres black			
6.3	1 070 841	1	Drive wheel left 14" Code 460-904-908
6.3a	1 070 842	1	Drive wheel right 14" Code 460-904-908
Code 904-909; Puncture proof tyres (standard profile) - tyre grey			
6.3	1 069 127	1	Drive wheel left 14" Code 460-904-909
6.3a	1 069 128	1	Drive wheel right 14" Code 460-904-909
Code 905-909; Pannensichere Bereifung (Stollenprofil) – Bereifung grau			
6.3	1 074 587	2	"Drive wheel 14" cleat profil puncture proof Code460-905-909

24.1

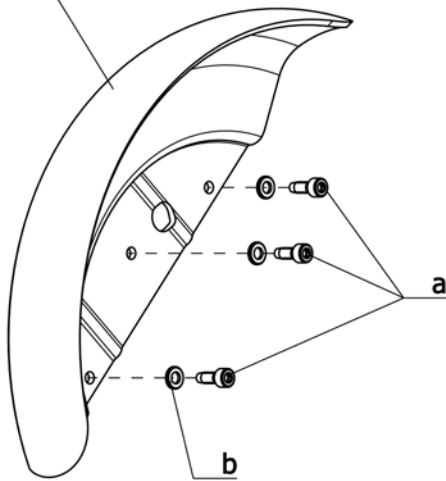
**Sub Unit: Code 824-460; Splash guard for drive wheel – Wheel size 14"**

Item	Article-No:	Pc	Description
-	1 070 520	1	Splash guard f drive wh. 14"" (1 pair) code 824
24.1	1 070 521	2	Splash guard f drive wh. 14"" 1 pc (w/o assembly parts)
a	207 650 800	6	CYLINDER SCREW M6X16 DIN7500 ST A3T
b	207 330 200	6	Washer,DIN 125-B6,4 St. A3T

iChair XXL / a
Component unit: Back support

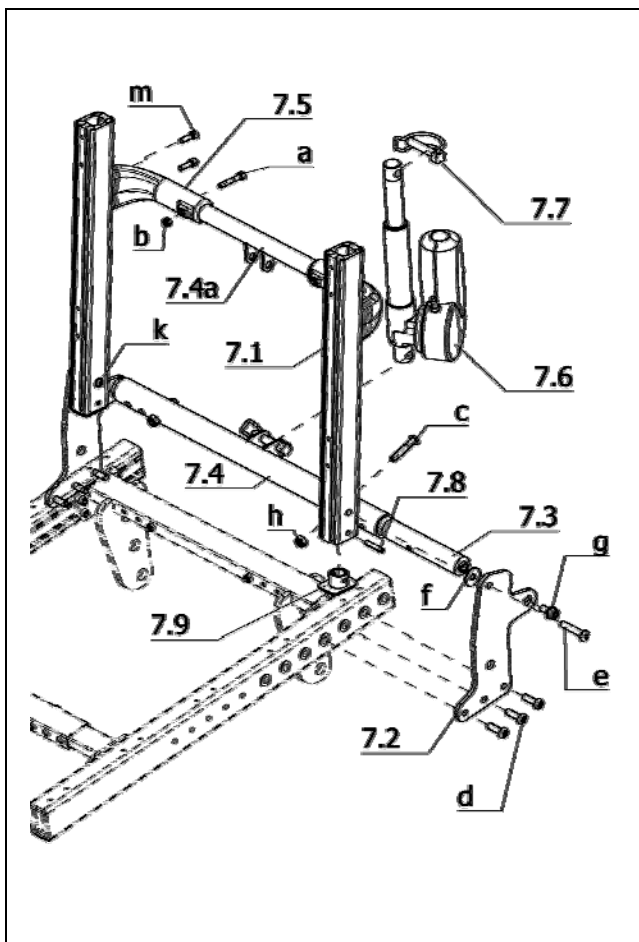

Sub Unit: Code 25; Electrically adjustable back support

Item	Article-No:	Pc	Description
7.1	1 067 260	2	Backrest tube
7.2	1 070 881	2	Adjustment plate
7.3	1 070 531	2	Connector pignion
7.5	1 069 947	2	Back bracket
7.6	1 073 369	1	Adjustment drive asmb. for Code25 (60degree) or Code118
7.7	205 662 000	2	Spring bolt 10x50
7.8	207 914 000	2	Dowel pin
7.9	1 069 952	2	Lower cap (back tube profile)
a	207 302 100	2	Cheese head screw, DIN 912 M 6x35-8.8
b	207 320 100	2	Locknut, DIN 980/8, M6, A3T
c	207 381 000	2	Filister head screw ISO 7380 M8x40-10.9 A3T
d	207 382 000	6	FILISTER HEAD SCREW W HEX.SOC. M 8 X 25 10.9 A2R
e	1 070 790	2	Hinge bolt
f	207 877 300	2	WASHER B/8.4 DIN 9021
g	205 592 600	2	Screw W251 M8x16
h	207 320 200	2	Locknut DIN 985 M8-8 A3T
k	209 005 400	2	Filister flat head screw, M6x12
m	207 300 800	4	Cheese head screw, DIN 912 M 6x20-8.8
-	1 071 616	1	Tilt switch (cable L=950mm)

->Attention! Tilt sensor shall always be fitted to the tube of the back support.

Sub Unit: Code 25; Electrically adjustable back support

Item	Article-No:	Pc	Description
-	1 075 572	1	Code 48/53/358; Seat width 48/53/58cm Back support code 25-48/53/58 (Please note seat width)
7.4	1 074 457	1	Lower horizontal connection
7.4a	1 073 492	1	Top horizontal connection

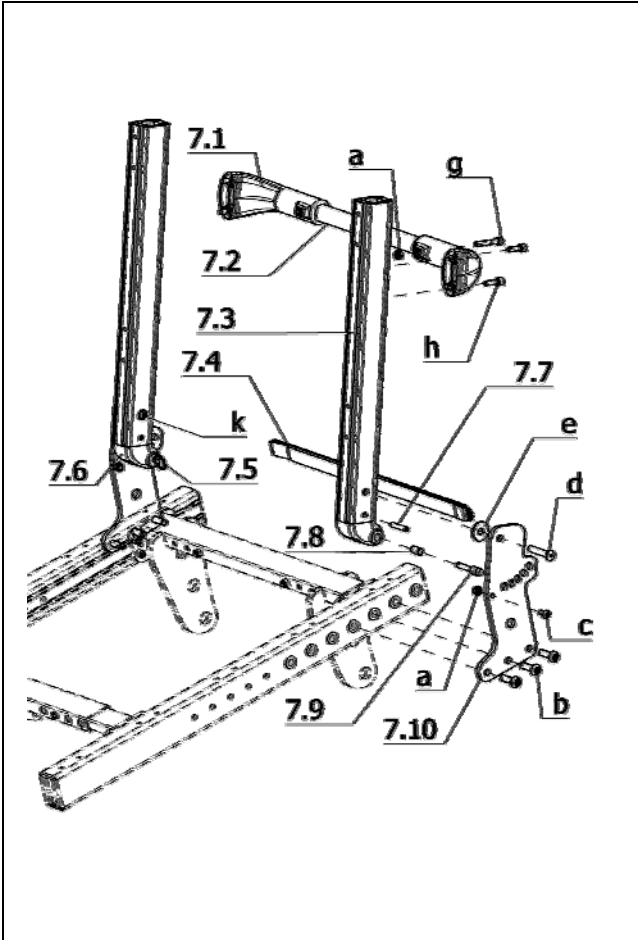

Sub Unit: Code 401; Back support mechan. adj.

Item	Article-No:	Pc	Description
7.1	1 069 947	2	Back bracket
7.3	1 067 260	2	Backrest tube
7.4	5 005 402	1	Release belt, seat width 33-45
7.5	205 636 600	2	Keyring, 20 mm
7.6	1 070 908	1	Back sup. locking device right
7.6a	1 070 907	1	Back sup. locking device left
7.7	207 914 000	2	Dowel pin
7.8	206 303 600	2	Compression spring D-160 D/9 D/1 19 long
7.9	1 069 943	2	Locking bolt
7.10	1 070 880	2	Adjustment plate
a	207 320 100	4	Locknut, DIN 980/8, M6, A3T
b	207 382 000	6	FILISTER HEAD SCREW W HEX.SOC. M 8 X 25 10.9 A2R
c	207 381 200	2	Filister head screw, M6 x 12 DIN 7380
d	1 070 790	2	Hinge bolt
e	207 877 300	2	WASHER B/8.4 DIN 9021
g	207 302 100	2	Cheese head screw, DIN 912 M 6x35-8.8
h	207 300 800	4	Cheese head screw, DIN 912 M 6x20-8.8
k	209 005 400	2	Filister flat head screw, M6x12
Code 48/53/358; Seat width 48/53/58cm			
-	1 073 499	1	Back support code 401-48/53/35 (Please note seat width)
7.2	1 073 498	1	Reinforcement tube, backrest SW 48/53/58

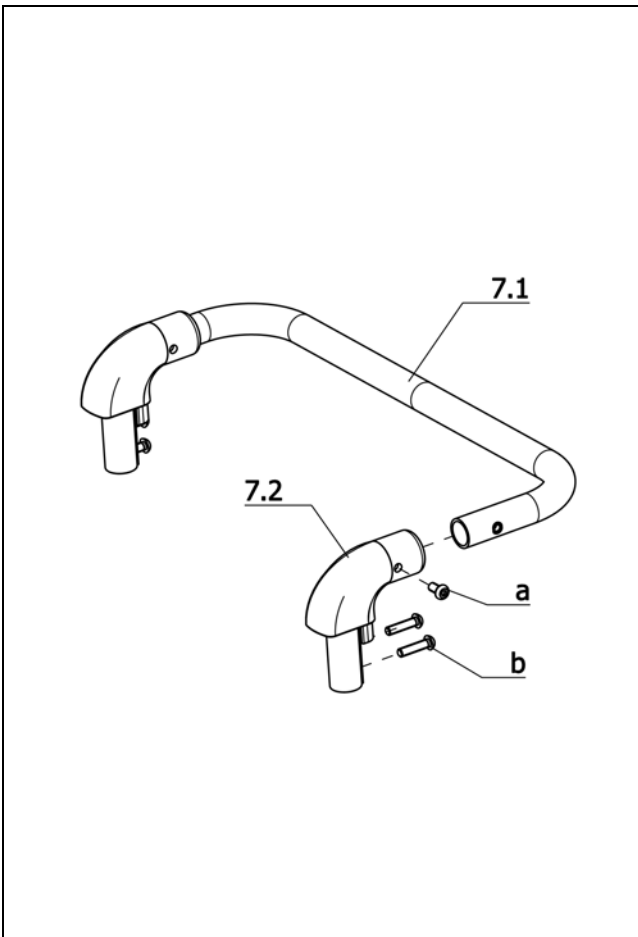

Sub Unit: Code 814; Horizontal pushing rod

Item	Article-No:	Pc	Description
7.2	1 067 263	2	Push handle bracket
a	207 382 500	2	FIL. HEAD SCREW HEX SOCK+FLAT M 6 X 12 10.9 LUG TUF-LO
b	207 380 100	4	Filister head screw
Code 48; Seat width 48cm			
7	1 070 547	1	Pushing bar asmb Code 48-814
7.1	1 070 546	1	Pushing bar
Code 53; Seat width 53cm			
7	1 070 549	1	Pushing bar asmb Code 53-814
7.1	1 070 550	1	Pushing bar
Code 358; Seat width 58 cm			
7	1 073 501	1	Pushing bar asmb Code 358-814
7.1	1 073 500	1	Pushing bar

iChair XXL / a
Component unit: Back support

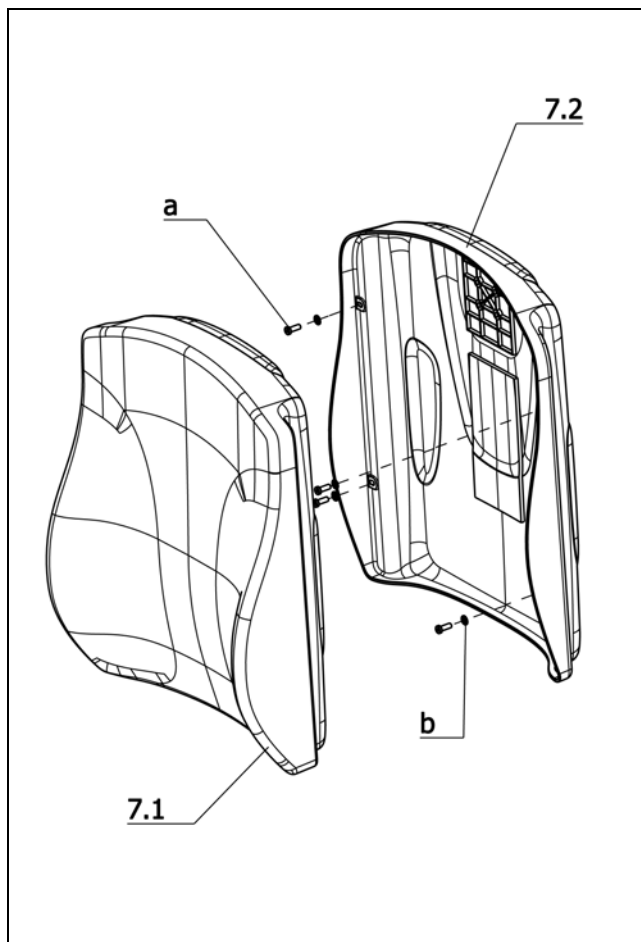

Sub Unit: Code 4980; Incontinency cover black

Item	Article-No:	Pc	Description
a	207 351 900	4	CYLINDER SCREW M 6 X 16 8.8
b	207 330 200	4	Washer, DIN 125-B6,4 St. A3T
			Code 48; Seat width 48cm
-	1 071 642	1	Back sup. ERGOSEAT asmb black Code 48-949-4980 incont.
7.1	1 071 592	1	Back cushion ERGOSEAT black Code 48-949-4980 incont.
7.2	1 068 726	1	Back shell asmb w/o cushion for cushion Code 48-949
			Code 53; Seat width 53cm
-	1 071 643	1	Back sup. ERGOSEAT asmb black Code 53-949-4980 incont.
7.1	1 071 593	1	Back cushion ERGOSEAT black Code 53-949-4980 incont.
7.2	1 071 599	1	Back shell asmb w/o cushion f uph. Code 53-949 ERGOSEAT
			Code 358; Seat width 58 cm
-	1 074 442	1	Back sup. ERGOSEAT asmb black Code 358-949-4980 incont.
7.1	1 070 916	1	Back cushion ERGOSEAT black Code 358-949-4980 incont.
7.2	1 074 462	1	Back shell asmb w/o cushion f.cushion Code358-949 ERGOSEAT

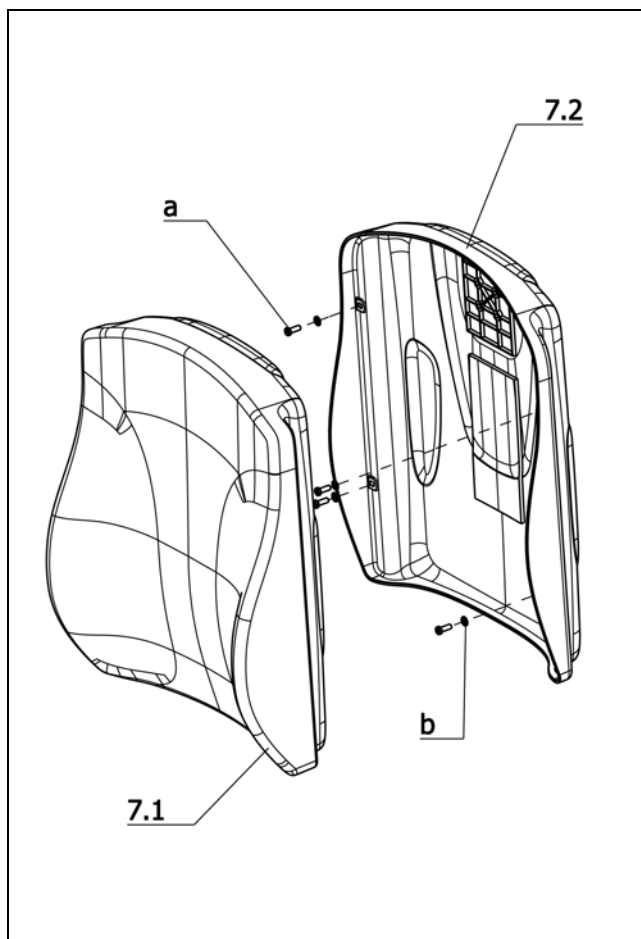

Sub Unit: Code 254; Synth. leather, black

Item	Article-No:	Pc	Description
a	207 351 900	4	CYLINDER SCREW M 6 X 16 8.8
b	207 330 200	4	Washer, DIN 125-B6,4 St. A3T
			Code 48; Seat width 48cm
-	1 071 646	1	Back sup. ERGOSEAT asmb black Code 48-254-949 synth.leath.
7.1	1 069 727	1	Back cushion ERGOSEAT black Code 48-254-949 synth.leath.
7.2	1 068 726	1	Back shell asmb w/o cushion for cushion Code 48-949
			Code 53; Seat width 53cm
-	1 071 647	1	Back sup. ERGOSEAT asmb black Code 53-254-949 synth.leath.
7.1	1 071 595	1	Back cushion ERGOSEAT black Code 53-254-949 synth.leath.
7.2	1 071 599	1	Back shell asmb w/o cushion f uph. Code 53-949 ERGOSEAT
			Code 358; Seat width 58 cm
-	1 074 444	1	Back sup. ERGOSEAT asmb black Code 358-254-949 synth.leath.
7.1	1 070 917	1	Back cushion ERGOSEAT black Code 358-254-949 synth.leath.
7.2	1 074 462	1	Back shell asmb w/o cushion f.cushion Code358-949 ERGOSEAT

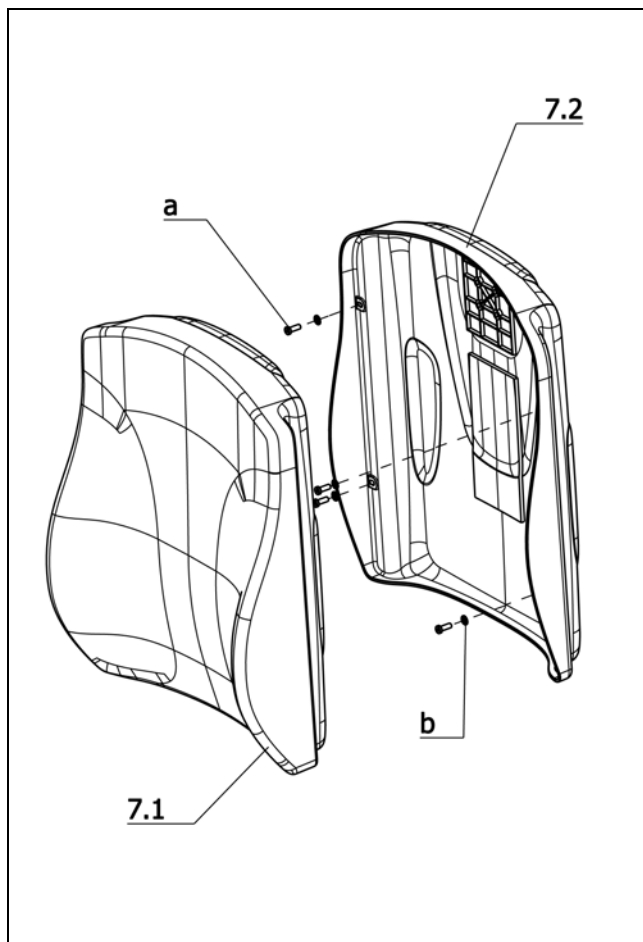

Sub Unit: Code 236; Graphite-grey-fabric

Item	Article-No:	Pc	Description
a	207 351 900	4	CYLINDER SCREW M 6 X 16 8.8
b	207 330 200	4	Washer, DIN 125-B6,4 St. A3T
Code 48; Seat width 48cm			
-	1 071 650	1	Back support ERGOSEAT assy Code 48-236-949 uph. grey
7.1	1 068 762	1	Back cushion ERGOSEAT for Code 48-236-949
7.2	1 068 726	1	Back shell asmb w/o cushion for cushion Code 48-949
Code 53; Seat width 53cm			
-	1 071 651	1	Back support ERGOSEAT assy Code 53-236-949 uph. grey
7.1	1 071 597	1	Back sup. uph. ERGOSEAT grey for Code 53-236-949 (fabric)
7.2	1 071 599	1	Back shell asmb w/o cushion f uph. Code 53-949 ERGOSEAT
Code 358; Seat width 58 cm			
-	1 074 443	1	Back support ERGOSEAT assy Code 358-236-949 uph. grey
7.1	1 070 918	1	Back sup. uph. ERGOSEAT grey for Code 358-236-949 (fabric)
7.2	1 074 462	1	Back shell asmb w/o cushion f.cushion Code358-949 ERGOSEAT

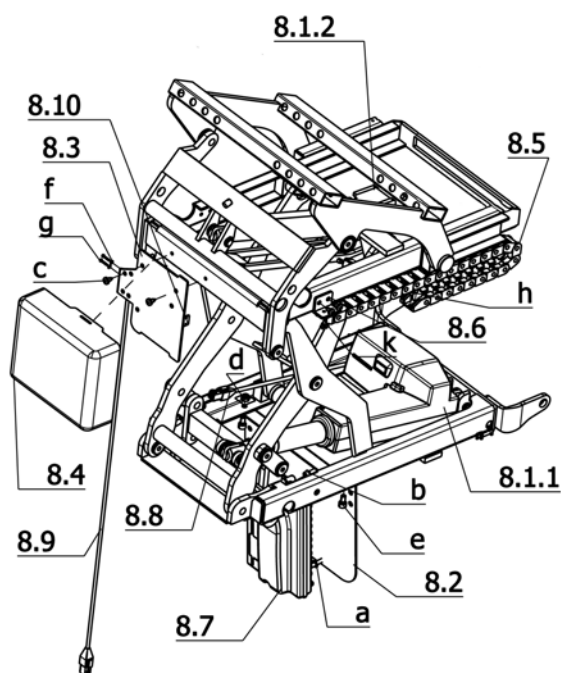
iChair XXL / a
Component unit: Seat

Sub Unit: Code 27; electric seat height adjustment

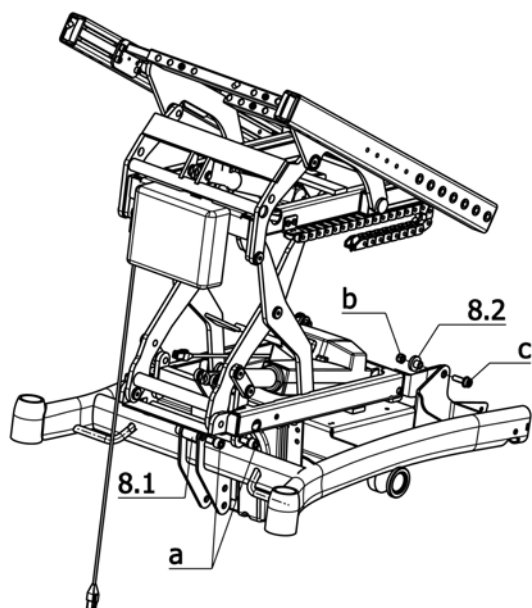
Item	Article-No:	Pc	Description
8.1.1	208 402 600	1	Adjustment motor seat lift 24V 4.3A LA31
8.1.2	208 402 500	1	Adjustment motor seat tilt 24V 4.5A LA28
8.2	1 072 671	1	Electronic plate
8.3	1 074 461	1	Tin
8.4	1 074 460	1	Canopy
8.5	1 073 595	1	Chain for cable management
8.6	1 072 679	1	Holding angle
8.7	0	0	view page Electronic
8.8	1 073 594	1	Motor cable
8.9	1 074 465	1	Microswitch (normally open contact)
8.10	1 002 413	1	Clamping piece
a	207 019 100	2	Self tapping screw M5x30 DIN-EN-ISO-7085 ST A3T
b	207 330 100	2	Washer DIN 125-B5,3 St A3T
c	207 318 500	4	Filister head tapping screw, DIN 7981 B 4,8x9,5
d	207 320 100	2	Locknut, DIN 980/8, M6, A3T
e	207 122 300	2	Cheese head screw DIN 912 M6x12 -8.8
f	207 028 400	2	Washer B2,2 DIN125
g	207 119 000	2	Cheese head screw DIN 84 M2 x 12 -5.8
h	207 395 100	2	Countersunk head tapping screw DIN 7982 B 3,5x9,5
k	207 344 900	2	Countersunk head screw M3x5 DIN965
-	206 907 800	1	BUS-cable 1.2m (R-NET)
-	1 074 466	1	Motor cable
-	206 986 000	3	Cable holder
-	206 986 100	4	Cable holder, black, Typ 130
-	206 954 200	6	CABLE BAND T 30 BLACK

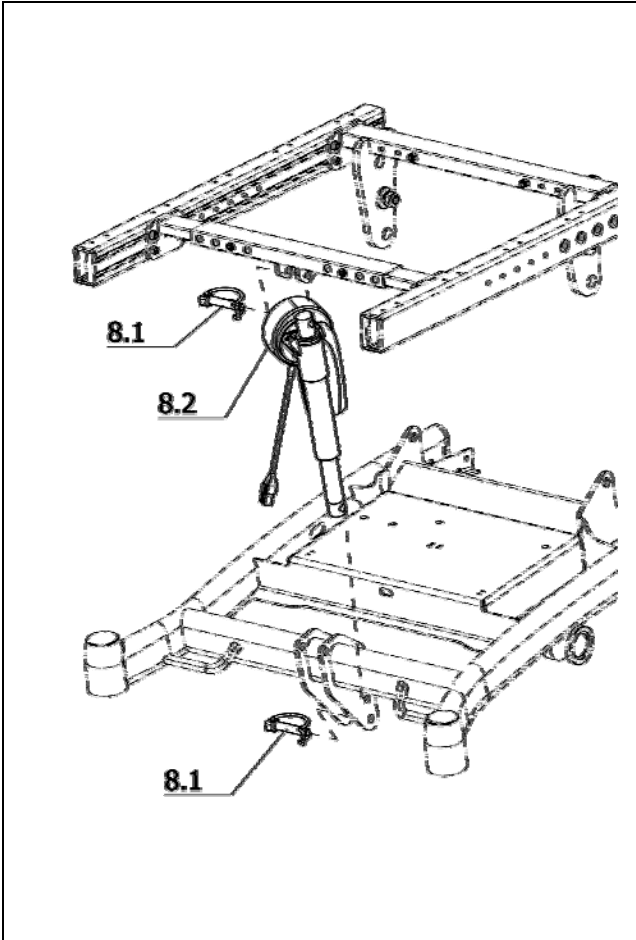

Sub Unit: Code 27; electric seat height adjustment

Item	Article-No:	Pc	Description
8.1	1 074 440	1	support
8.2	1 072 672	2	Flange sleeve
a	205 598 000	2	Hexagon screw M8x25 VERBUSRIPP
b	207 320 200	2	Locknut DIN 985 M8-8 A3T
c	207 304 200	4	Cylinder screw M 10 x 20 DIN912 8.8 A3T

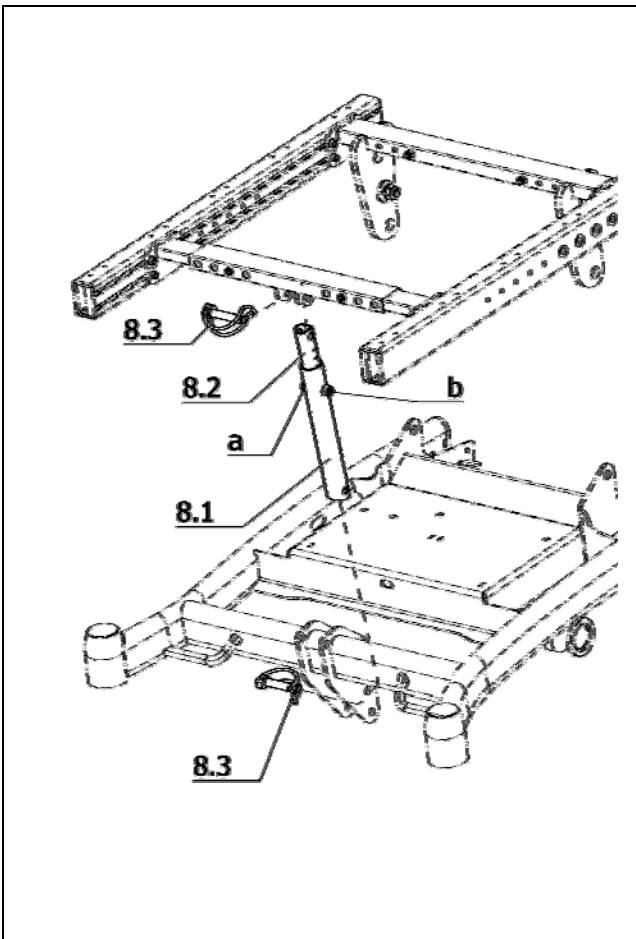

Sub Unit: Code 118; Seat angle adjustment electric

Item	Article-No:	Pc	Description
8	1 073 368	1	Seat angle adjustment electric Code 118 asmb.
8.1	205 662 000	2	Spring bolt 10x50
8.2	1 073 369	1	Adjustment drive asmb. for Code25 (60degree) or Code118



Sub Unit: Code 119; Seat angle adjustment mechanical

Item	Article-No:	Pc	Description
8	1 073 395	1	Seat tilt mechanical asmb. Code 119
8.1	1 073 397	1	Receptacle tube for Code 119
8.2	1 073 396	1	Adjustment tube for Code 119
8.3	205 662 000	2	Spring bolt 10x50
a	207 320 200	1	Locknut DIN 985 M8-8 A3T
b	207 139 200	1	Cheese head screw DIN 912 M8x35 8.8 A3K

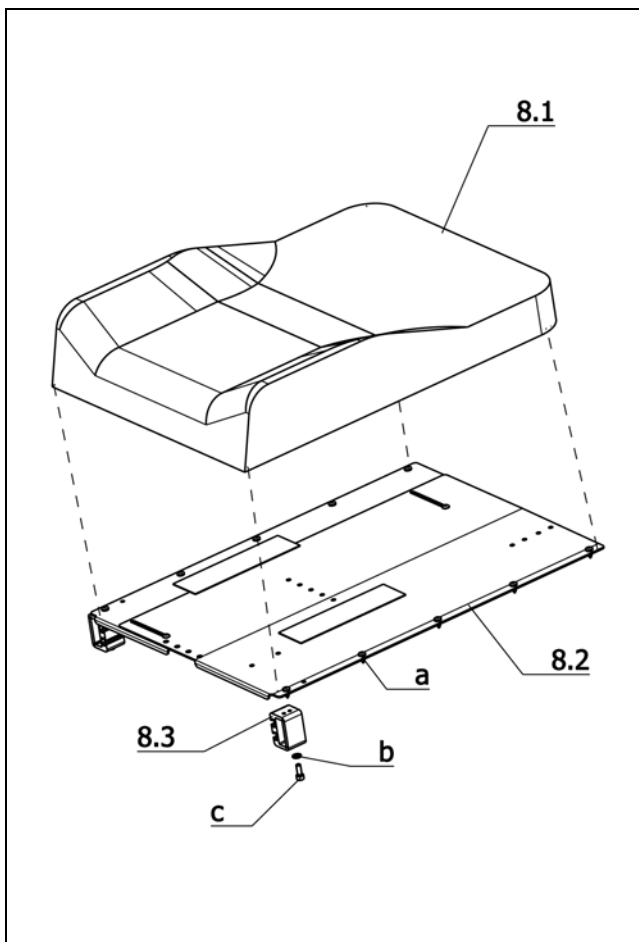
iChair XXL / a
Component unit: Seat

Sub Unit: Code 4980; Incontinency cover black

Item	Article-No:	Pc	Description
a	207 319 300	12	Filister head screw DIN 7981 B4,8x13
8.2	1 073 400	1	Seat tin asmb Code 4276 Code 360; Seat depth 60cm
8.3	1 071 688	2	Seat profile extension 30mm
b	207 330 200	4	Washer, DIN 125-B6,4 St. A3T
c	207 124 500	4	Cheese head screw DIN 912 M 6x16-8.8 VC3 Code 48; Seat width 48cm
8	1 073 433	1	ERGOSEAT seat asmb incont. Code 48-619/788/792-948-4980
8.1	1 071 516	1	Seat pad ERGOSEAT incont. Code 48-619/792-948-4980
8	1 073 427	1	ERGOSEAT seat asmb incont. Code 48-356/360/793-948-4980
8.1	1 073 418	1	Seat pad ERGOSEAT incont. Code 48-356/360/793-948-4980

Sub Unit: Code 4980; Incontinency cover black

Item	Article-No:	Pc	Description
			Code 53; Seat width 53cm
8	1 073 434	1	ERGOSEAT seat asmb incont. Code 53-619/788/792-948-4980
8.1	1 071 517	1	Seat pad ERGOSEAT incont. Code 53-619/792-948-4980
8	1 073 428	1	ERGOSEAT seat asmb incont. Code 53-356/360/793-948-4980
8.1	1 073 419	1	Seat pad ERGOSEAT incont. Code 53-356/360/793-948-4980

Sub Unit: Code 4980; Incontinency cover black

Item	Article-No:	Pc	Description
			Code 358; Seat width 58 cm
8	1 073 439	1	ERGOSEAT seat asmb incont. Code 358-356/360-948-4980
8.1	1 073 420	1	Seat pad ERGOSEAT incont. Code 358-356/360-948-4980

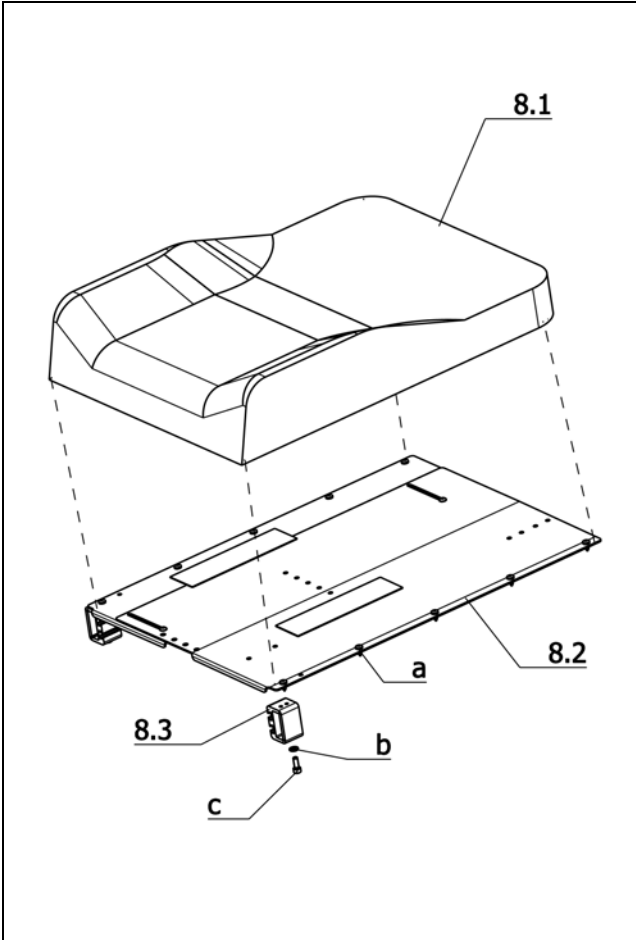

Sub Unit: Code 254; Synth. leather, black

Item	Article-No:	Pc	Description
a	207 319 300	12	Filister head screw DIN 7981 B4,8x13
8.2	1 073 400	1	Seat tin asmb Code 4276 Code 360; Seat depth 60cm
8.3	1 071 688	2	Seat profile extension 30mm
b	207 330 200	2	Washer, DIN 125-B6,4 St. A3T
c	207 124 500	2	Cheese head screw DIN 912 M 6x16-8.8 VC3 Code 48; Seat width 48cm
8	1 073 536	1	ERGOSEAT seat asmb synt.leath. Code 48-254-619/788/792-948
8.1	1 071 528	1	Seat pad ERGOSEAT synth.leath. Code 48-254-619/792-948
8	1 073 529	1	ERGOSEAT seat asmb synt.leath. Code 48-254-356/360/793-948
8.1	1 073 421	1	Seat pad ERGOSEAT synth.leath. Code 48-254-356/360/793-948

Sub Unit: Code 254; Synth. leather, black

Item	Article-No:	Pc	Description
			Code 53; Seat width 53cm
8	1 073 535	1	ERGOSEAT seat asmb synt.leath. Code 53-254-619/788/792-948
8.1	1 071 529	1	Seat pad ERGOSEAT synth.leath. Code 53-254-619/792-948
8	1 073 530	1	ERGOSEAT seat asmb synt.leath. Code 53-254-356/360/793-948
8.1	1 073 422	1	Seat pad ERGOSEAT synth.leath. Code 53-254-356/360/793-948

Sub Unit: Code 254; Synth. leather, black

Item	Article-No:	Pc	Description
			Code 358; Seat width 58 cm
8	1 073 525	1	ERGOSEAT seat asmb synt.leath. Code 358-254-356/360-948
8.1	1 073 423	1	Seat pad ERGOSEAT synth.leath. Code 358-254-356/360-948

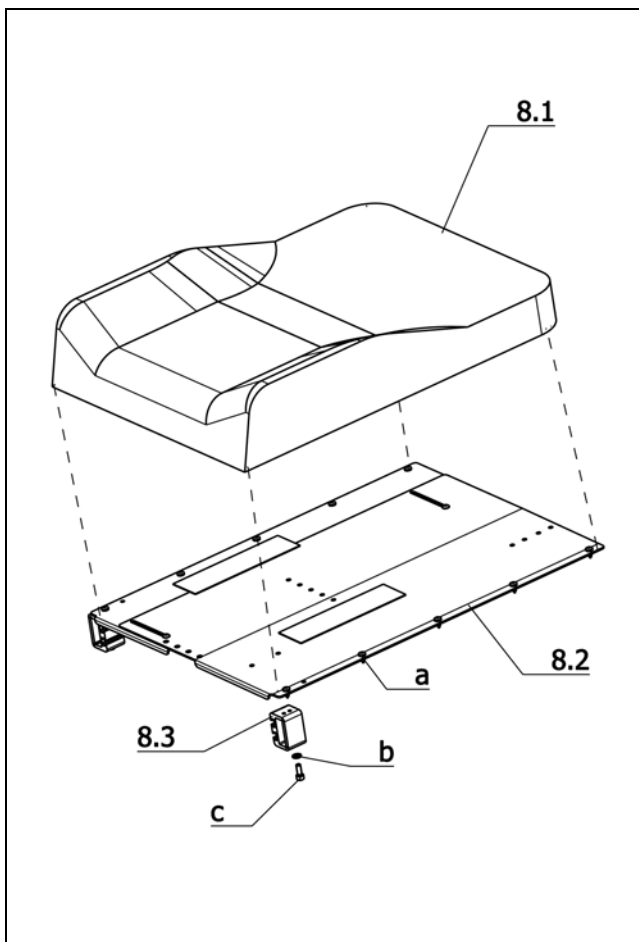
iChair XXL / a
Component unit: Seat

Sub Unit: Code 236; Graphite-grey-fabric

Item	Article-No:	Pc	Description
a	207 319 300	12	Filister head screw DIN 7981 B4,8x13
8.2	1 073 400	1	Seat tin asmb Code 4276 Code 360; Seat depth 60cm
8.3	1 071 688	2	Seat profile extension 30mm
b	207 330 200	2	Washer, DIN 125-B6,4 St. A3T
c	207 124 500	2	Cheese head screw DIN 912 M 6x16-8.8 VC3 Code 48; Seat width 48cm
8	1 073 548	1	ERGOSEAT seat asmb fabr. grey Code 48-236-619/788/792-948
8.1	1 071 538	1	Seat pad ERGOSEAT grey For code 48-236-619/792-948
8	1 073 541	1	ERGOSEAT seat asmb fabr. grey Code 48-236-356/360/793-948
8.1	1 073 424	1	Seat pad ERGOSEAT grey f.Code 48-236-356/360/793-948

Sub Unit: Code 236; Graphite-grey-fabric

Item	Article-No:	Pc	Description
			Code 53; Seat width 53cm
8	1 073 549	1	ERGOSEAT seat asmb fabr. grey Code 53-236-619/788/792-948
8.1	1 071 539	1	Seat pad ERGOSEAT grey For code 53-236-619/792-948
8	1 073 544	1	ERGOSEAT seat asmb fabr. grey Code 53-236-356/360/793-948
8.1	1 073 425	1	Seat pad ERGOSEAT grey f.Code 53-236-356/360/793-948

Sub Unit: Code 236; Graphite-grey-fabric

Item	Article-No:	Pc	Description
			Code 358; Seat width 58 cm
8	1 073 527	1	ERGOSEAT seat asmb fabr. grey Code 358-236-356/360-948
8.1	1 073 426	1	Seat pad ERGOSEAT grey f.Code 358-236-356/360-948

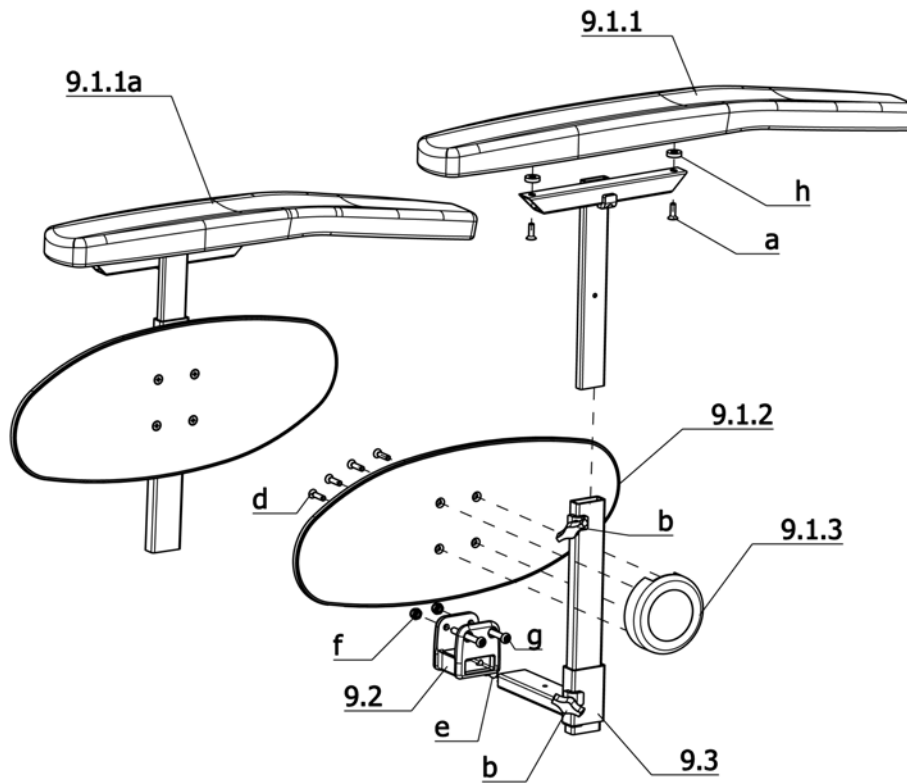

Sub Unit: Code 21; Arm supports, detachable, large, height adj., cushion

Item	Article-No:	Pc	Description
9.1.2	1 069 936	2	Clothes guard plate Transparent
9.1.3	1 069 948	2	Clothes guard bracket
9.1.4	1 070 460	2	Receptacle tube L=250 mm
9.2	1 069 934	2	Arm support receptacle
9.3	1 070 466	2	Adj. tube long (L=140mm)
a	207 633 400	4	Countersunk head screw DIN 7991 M6x16
b	205 113 800	4	Wing screw M8x15
d	8 452 755	8	Plastic screw KB50X20
e	207 510 300	2	Threaded pin DIN 914 M8x16
f	207 320 100	4	Locknut, DIN 980/8, M6, A3T
g	207 381 400	4	FIL.HEAD SCREW M 6X50 ISO7380 10.9 A3T WITH HEX. SOCKET
h	205 155 700	4	Distancer sleeve, black "D=15

Sub Unit: Code 21; Arm supports, detachable, large, height adj., cushion

Item	Article-No:	Pc	Description
			Code 60; Operation opposite to the standard version (left)
-	1 073 691	1	Arm supports Code 21-60 pad large, clothes guard transp.1pa
9.1	1 073 686	1	Arm support Code21-60left asmb with clothes guard transp.pad
9.1a	1 073 687	1	Arm support Code21-60right asm with clothes guard transp.pad
9.1.1	1 070 913	1	Arm support pad short "L=517;B=80mm -OM-side"
9.1.1a	1 070 912	1	Arm support pad long "L=597;B=80mm -side w/o OM"
			Code 74; Operation standard version (right)
-	1 073 690	1	Arm supports Code 21-74 pad large, clothes guard transp.1pa
9.1	1 073 684	1	Arm support Code21-74left asmb with clothes guard transp.pad
9.1a	1 073 685	1	Arm support Code21-74right asm with clothes guard transp.pad
9.1.1	1 070 912	1	Arm support pad long "L=597;B=80mm -side w/o OM"
9.1.1a	1 070 913	1	Arm support pad short "L=517;B=80mm -OM-side"

iChair XXL / a
Component unit: Arm support

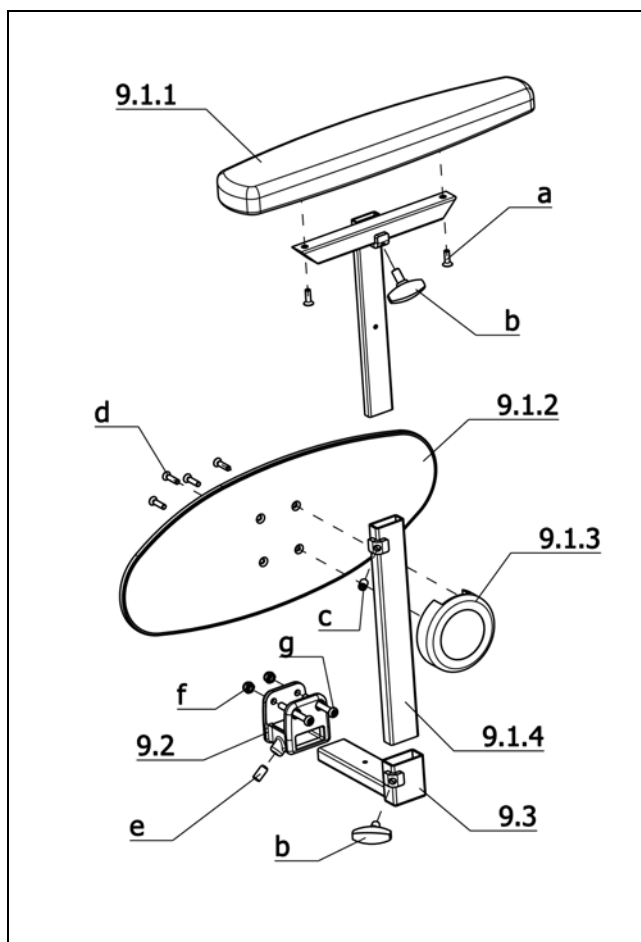

Sub Unit: Code 106; Arm support cushioned, removable, L, height adj.

Item	Article-No:	Pc	Description
-	1 070 892	1	Arm supports Code 106-standard (1 pair)
9.1	1 070 890	1	Arm support standard left asmb w clothes guard and pad
9.1a	1 070 891	1	Arm support stand. right asmb w clothes guard and pad
-	1 070 462	2	Arm support (T-tube pad rec.)
9.1.1	1 070 451	2	Arm support pad standard "(L=380mm
9.1.2	1 069 936	2	Clothes guard plate Transparent
9.1.3	1 069 948	2	Clothes guard bracket
9.1.4	1 070 460	2	Receptacle tube L=250 mm
9.2	1 069 934	2	Arm support receptacle
9.3	1 070 466	2	Adj. tube long (L=140mm)
a	207 633 400	4	Countersunk head screw DIN 7991 M6x16
b	205 113 800	4	Wing screw M8x15
c	207 306 100	2	THREAD PIN WITH BALL CAP M 8 X 12 45H
d	8 452 755	8	Plastic screw KB50X20
e	207 510 300	2	Threaded pin DIN 914 M8x16
f	207 320 100	4	Locknut, DIN 980/8, M6, A3T
g	207 381 400	4	FIL.HEAD SCREW M 6X50 ISO7380 10.9 A3T WITH HEX. SOCKET

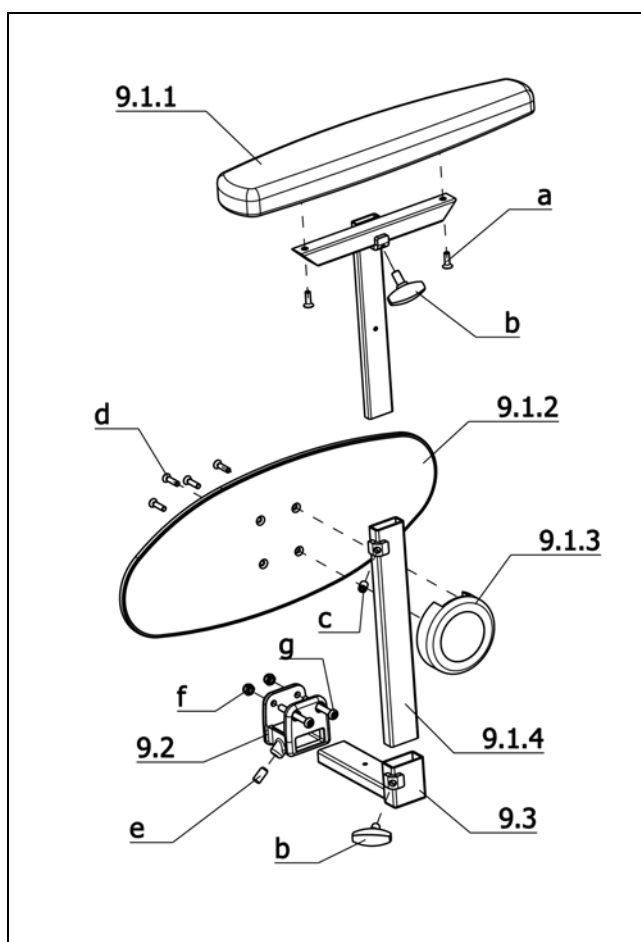

Sub Unit: Code 4960; Adapter set for Hemi arm support pad

Item	Article-No:	Pc	Description
-	1 070 893	1	Arm supports Code 4960-HEMI (1 pair)
-	1 070 462	2	Arm support (T-tube pad rec.)
9.1	1 070 894	1	Arm support HEMI left asmb w clothes guard and pad
9.1a	1 070 895	1	Arm support HEMI right asmb w clothes guard and pad
9.1.1	1 069 946	2	Arm support cushion hemi-shell "(L=380mm
9.1.2	1 069 936	2	Clothes guard plate Transparent
9.1.3	1 069 948	2	Clothes guard bracket
9.1.4	1 070 460	2	Receptacle tube L=250 mm
9.2	1 069 934	2	Arm support receptacle
9.3	1 070 466	2	Adj. tube long (L=140mm)
a	207 633 400	4	Countersunk head screw DIN 7991 M6x16
b	205 113 800	4	Wing screw M8x15
c	207 306 100	2	THREAD PIN WITH BALL CAP M 8 X 12 45H
d	8 452 755	8	Plastic screw KB50X20
e	207 510 300	2	Threaded pin DIN 914 M8x16
f	207 320 100	4	Locknut, DIN 980/8, M6, A3T
g	207 381 400	4	FIL.HEAD SCREW M 6X50 ISO7380 10.9 A3T WITH HEX. SOCKET

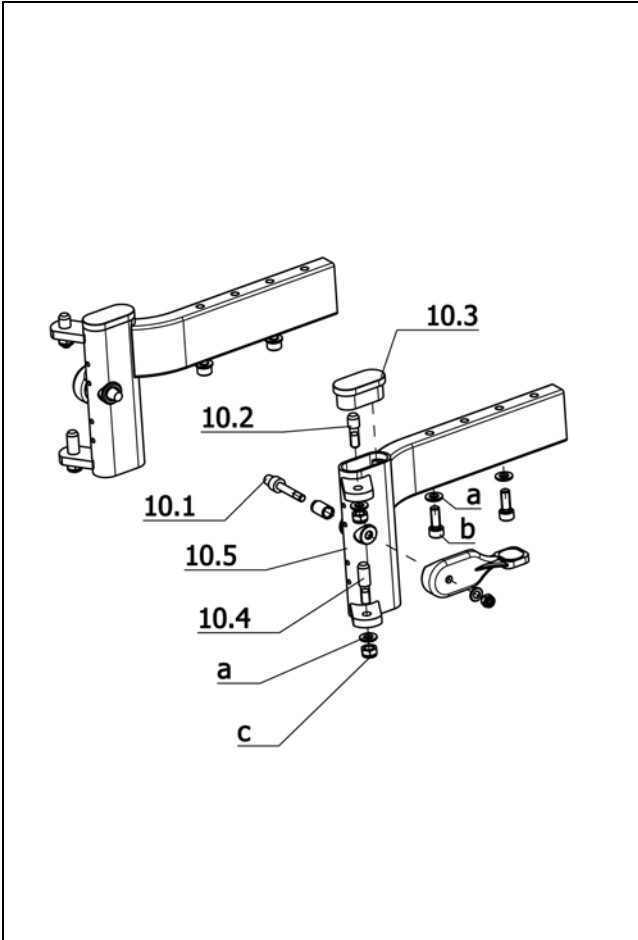

Sub Unit: Bracket asmb. manual

Item	Article-No:	Pc	Description
10	5 006 638	1	Bracket left asmb. (manual leg support)
10a	5 006 639	1	Bracket right asmb. (manual leg support)
10.1	5 006 642	2	Leg support release lever
10.2	1 002 772	2	Screw 25 mm long
10.3	205 049 700	2	Plastic slide, 40 x 20 x 2
10.4	1 002 773	2	Screw 31 mm long
10.5	1 072 653	1	Insert tube left
10.5a	1 072 654	1	Insert tube right
a	207 320 100	8	Locknut, DIN 980/8, M6, A3T
b	207 124 500	4	Cheese head screw DIN 912 M 6x16-8.8 VC3
c	207 320 100	4	Locknut, DIN 980/8, M6, A3T

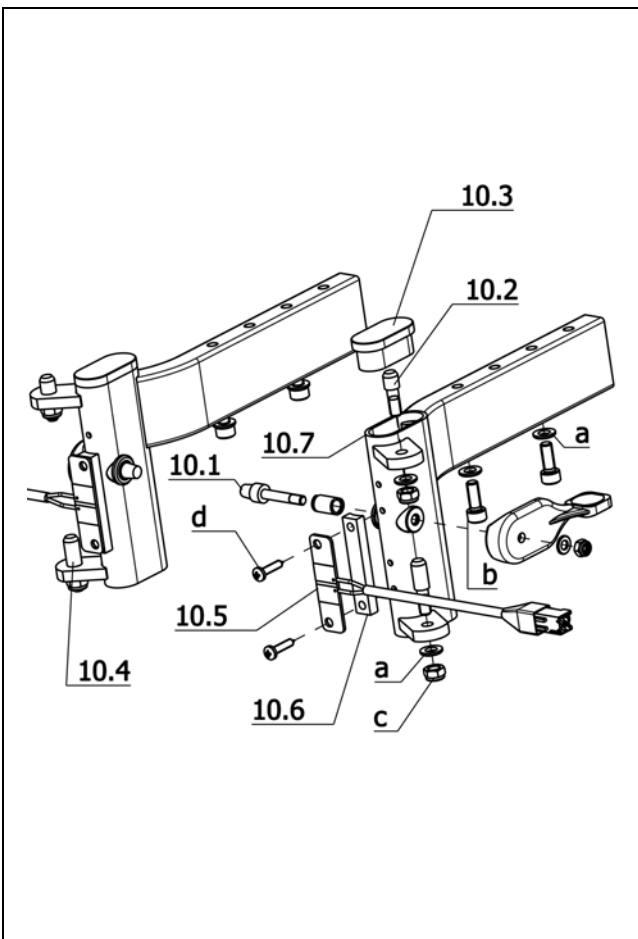

Sub Unit: Bracket asmb. electric

Item	Article-No:	Pc	Description
10	5 006 641	1	Bracket left asmb. (electric leg support)
10a	5 006 640	1	Bracket right asmb. (electric leg support)
10.1	5 006 642	2	Leg support release lever
10.2	1 002 772	2	Screw 25 mm long
10.3	205 049 700	2	Plastic slide, 40 x 20 x 2
10.4	1 002 773	2	Screw 31 mm long
10.5	1 073 562	2	Leg support cable asmb.
10.6	1 036 222	2	Pcb support
10.7	1 072 653	1	Insert tube left
10.7a	1 072 654	1	Insert tube right
a	207 330 200	8	Washer, DIN 125-B6,4 St. A3T
b	207 124 500	4	Cheese head screw DIN 912 M 6x16-8.8 VC3
c	207 320 100	4	Locknut, DIN 980/8, M6, A3T
d	207 318 200	4	Filister head tapping screw DIN 7981 B 3,9x19

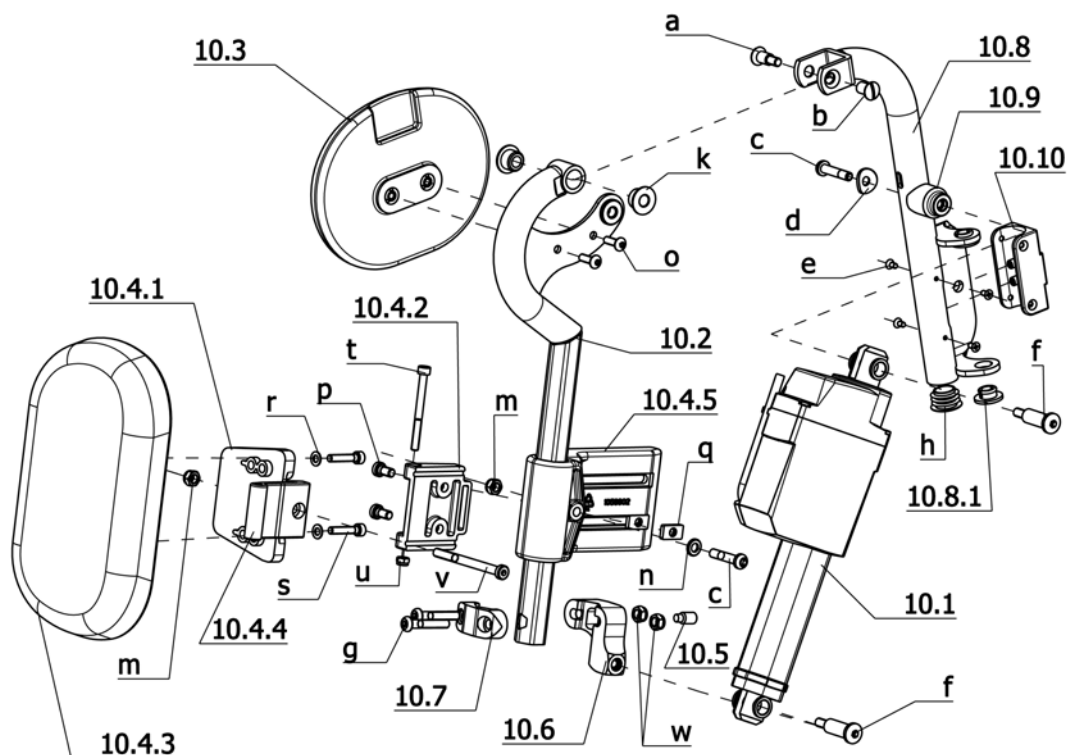
iChair XXL / a
Component unit: Leg supports

Sub Unit: Code 86; Leg support electrically adj.

Item	Article-No:	Pc	Description
-	1 072 660	1	Upper leg supports electric Code 86 - 1 pair (refit kit)
-	1 072 661	1	Upper leg supports left asmb. Code 86 (w/o bracket)
-	1 072 662	1	Upper leg supports right asmb. Code 86 (w/o bracket)
10.1	206 922 300	2	"Adjustment drive 2500N;" "L=265mm; Lift=150mm"
-	1 072 669	1	Actuator cable
-	206 909 100	1	Cable protection
10.2	1 058 915	1	Calf plate tube left cpl.
10.2a	1 059 443	1	Calf plate tube right cpl. .
10.3	1 053 701	2	Knee cushion
10.4	5 006 345	2	Calf cushion asmb.
10.4.1	1 059 657	2	Swivelling plate
10.4.2	1 061 036	2	Joint bracket long
10.4.3	1 059 656	2	Calf plat slim
10.4.4	1 059 655	2	Joint
10.4.5	1 058 902	2	Support clamp
10.5	207 515 200	2	threaded pin with pivot M 8X16 45H A2R 433789/404608
10.6	1 072 657	1	Left connector
10.6a	1 072 658	1	Right connector
10.7	1 072 659	2	Clamp
10.8	1 072 665	1	Leg support tube left
10.8.1	205 009 806	4	Hinge bush, black, RAL 9005
10.8a	1 072 666	1	Leg support tube right

Sub Unit: Code 86; Leg support electrically adj.

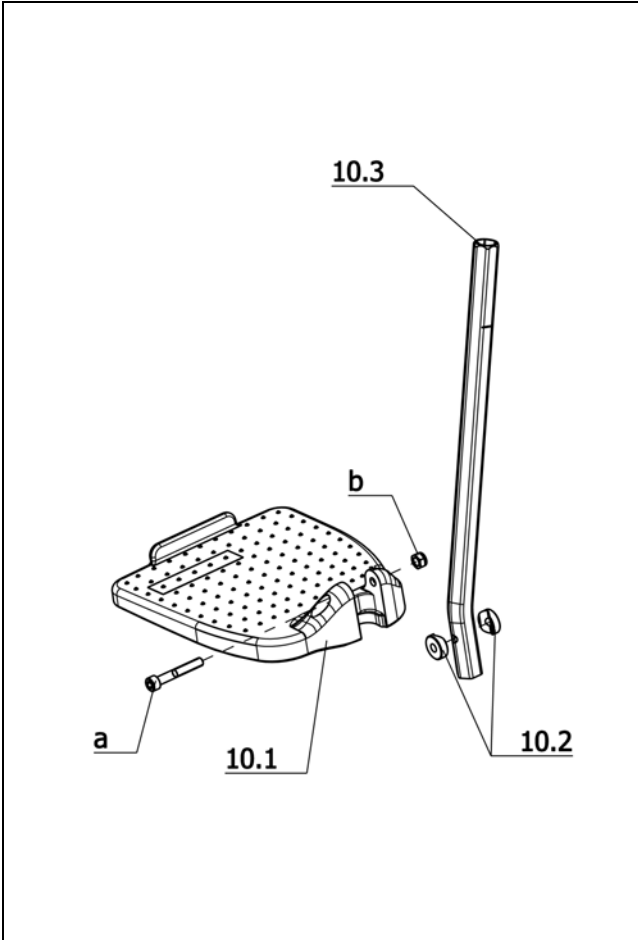
Item	Article-No:	Pc	Description
10.9	1 072 663	2	Distancer sleeve
10.10	1 058 528	2	Contact bit asmb
a	205 596 200	2	Shoulder screw 95MNPB 28K
b	205 596 100	2	Sleeve nut M6 black 9S20K ->Attention! Secure sleeve nut and shoulder screw with Loctite no. 243 article-no. 205 638 800.
c	207 380 200	8	Filister head screw DIN 7380 M 6x30 10,9 A3T
d	8 454 744	2	WASHER FORGED R 12.5
e	207 395 100	8	Countersunk head tapping screw DIN 7982 B 3,5x9,5
f	1 072 646	4	Shoulder screw M6
g	207 380 400	4	Filister head screw DIN 7380 M 6x35-10,9 A3T
h	205 047 400	2	Round plug 22, 22x1,5 SFL
k	1 047 682	4	Bush sleeve
m	207 320 100	2	Locknut,DIN 980/8,M6, A3T
n	207 330 200	2	Washer,DIN 125-B6,4 St. A3T
o	207 381 600	4	Filister head screw
p	207 350 200	4	Cheese head screw,M 6x12-8.8 A3T DIN6912
q	1 061 035	4	Square nut M6
r	207 330 100	4	Washer DIN 125-B5,3 St A3T
s	207 120 800	4	Cheese head screw DIN 912 M 5x25-8.8
t	207 304 100	2	Cheese head screw DIN 912 M 5x55-8.8
u	207 322 000	2	Locknut,DIN 980/8,M5
v	207 351 000	2	Cheese head screw DIN 7984 M 6x70-8.8
w	207 320 100	4	Locknut,DIN 980/8,M6, A3T
-	1 036 222	2	Pcb support



Sub Unit: Code 805; Foot plates plastic, divided

Item	Article-No:	Pc	Description
-	1 073 502	1	Insert tubes Code 805-122 - 1 pair
10	1 073 503	1	Footboard left asmb. Code 805-122
10a	1 073 504	1	Footboard right asmb. Code 805-122
10.1	1 053 031	1	Footboard left for Code 43/45/46/48-805
10.1a	1 053 029	1	Footboard right for Code 43/45/46/48-805
10.2	1 058 905	4	Joint washer
10.3	1 058 910	2	Insert tube
a	207 302 200	2	Cheese head screw DIN 912 M6x40
b	207 320 100	2	Locknut,DIN 980/8,M6, A3T

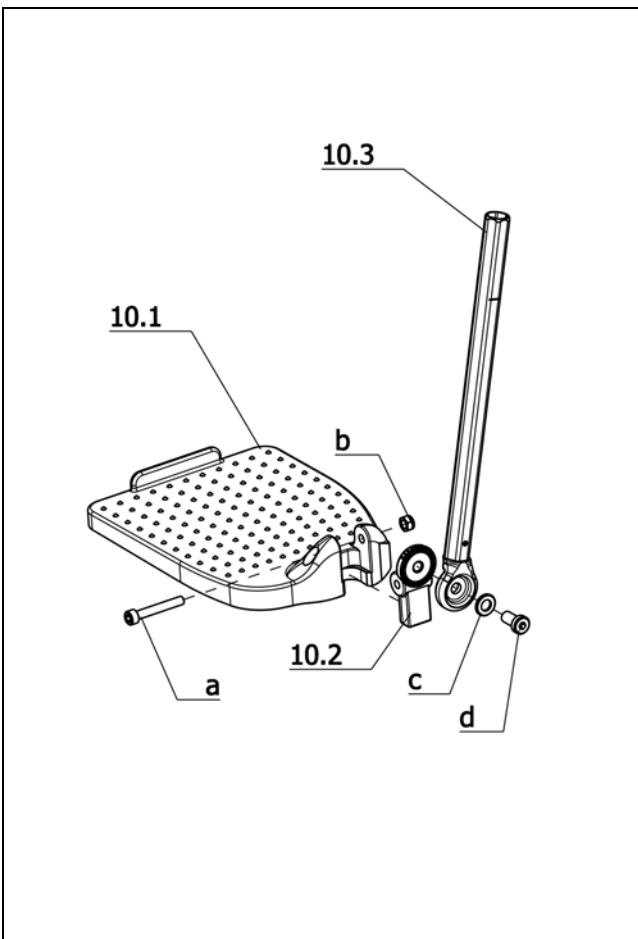

Sub Unit: Code 808; Foot plates angle adjustable

Item	Article-No:	Pc	Description
-	1 073 505	1	Lower leg supports Code 122-798/808 - 1 pair
10	1 073 507	1	Footboard left asmb. Code 122-798/808
10a	1 073 506	1	Footboard right asmb. Code 122-798/808
10.1	1 053 031	1	Footboard left for Code 43/45/46/48-805
10.1a	1 053 029	1	Footboard right for Code 43/45/46/48-805
10.2	1 058 918	2	Toothed insert
10.3	1 059 465	2	Insert tube
a	207 302 200	2	Cheese head screw DIN 912 M6x40
b	207 320 100	2	Locknut,DIN 980/8,M6, A3T
c	207 330 300	2	Washer DIN 125 - B8,4 ST A3T
d	207 353 000	2	Cheese head screw M8 X 16 DIN984 8.8 A3T VC3

iChair XXL / a
Component unit: Leg supports

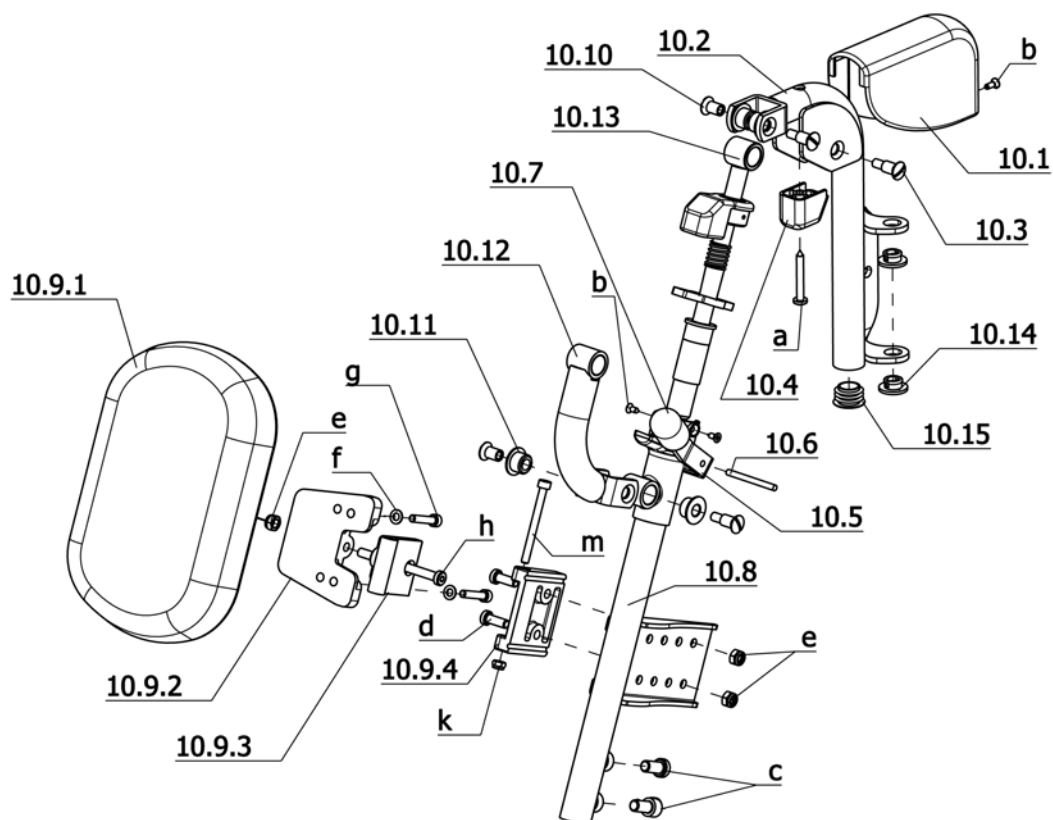

Sub Unit: Code 91; removable height adj. leg support, automatic length alignment, swivell-away (hexagon tube)

Item	Article-No:	Pc	Description
-	1 075 050	1	Upper leg supports Code 91 - 1 pair
-	1 075 048	1	Upper leg supports left asmb.
-	1 075 049	1	Upper leg supports right asmb.
10.1	205 208 506	2	Shrouding cover
10.2	1 044 589	1	Swivel tube, left, complete
10.2a	1 044 590	1	Swivel tube, right, complete
10.3	205 596 200	6	Shoulder screw 9SMNPB 28K
10.4	205 210 106	2	Limit stop PA6 black
10.5	1 033 873	2	Release lever
10.6	207 907 700	2	Center-grooved dowel pin DIN 1475 4x45
10.7	205 013 406	2	Handle piece, black soft PVC 70 RAL 9005
10.8	1 075 051	1	Guide tube left
10.8a	1 075 052	1	Guide tube right
10.9	5 005 921	2	Calf padding, assembled
10.9.1	205 104 006	2	Calf cover, black
10.9.2	205 209 706	2	Swivel plate PA6 black
10.9.3	205 209 906	2	Hinge PA6 black
10.9.4	205 209 806	2	Hinge carrier PA6 black
10.10	205 596 100	6	Sleeve nut M6 black 9S20K
10.11	1 033 991	12	Bush/sleeve
10.12	1 033 985	2	Connecting tube, complete
10.13	1 033 984	2	Guiding bar/rod, compl.
10.14	205 009 806	4	Hinge bush, black, RAL 9005

Sub Unit: Code 91; removable height adj. leg support, automatic length alignment, swivell-away (hexagon tube)

Item	Article-No:	Pc	Description
10.15	205 047 400	2	Round plug 22, 22x1,5 SFL
a	207 318 300	2	Filister head tapping screw DIN 7981 B 4,8x38
b	207 395 100	6	Countersunk head tapping screw DIN 7982 B 3,5x9,5
c	207 353 000	4	Cheese head screw M8 X 16 DIN7984 8.8 A3T VC3
d	207 114 900	6	Cheese head screw, M6x16 DIN7984 - 8.8 A3T
e	207 320 100	4	Locknut, DIN 980/8, M6, A3T
f	207 330 100	4	Washer DIN 125-B5, 3 St A3T
g	207 120 800	4	Cheese head screw DIN 912 M 5x25-8.8
h	207 351 000	2	Cheese head screw DIN 7984 M 6x70-8.8
k	207 322 000	2	Locknut, DIN 980/8, M5
m	207 304 100	2	Cheese head screw DIN 912 M 5x55-8.8
-	206 322 700	2	Compression spring D-206F
-	1 033 884	2	Clamping piece
-	205 210 606	2	Closing cap PA6 black

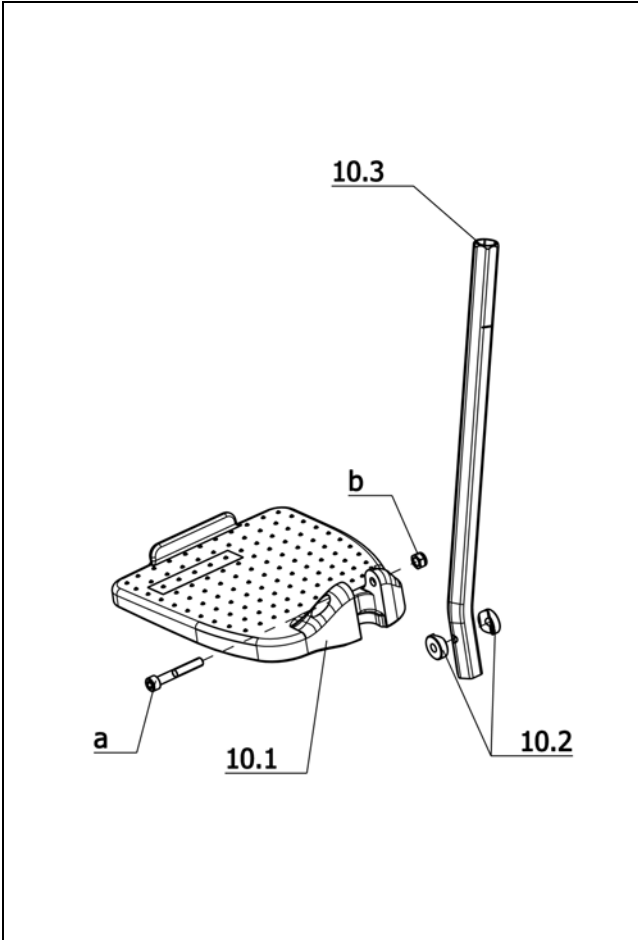

Sub Unit: Code 805; Foot plates plastic, divided

Item	Article-No:	Pc	Description
-	1 073 502	1	Insert tubes Code 805-122 - 1 pair
10	1 073 503	1	Footboard left asmb. Code 805-122
10a	1 073 504	1	Footboard right asmb. Code 805-122
10.1	1 053 031	1	Footboard left for Code 43/45/46/48-805
10.1a	1 053 029	1	Footboard right for Code 43/45/46/48-805
10.2	1 058 905	4	Joint washer
10.3	1 058 910	2	Insert tube
a	207 302 200	2	Cheese head screw DIN 912 M6x40
b	207 320 100	2	Locknut,DIN 980/8,M6, A3T

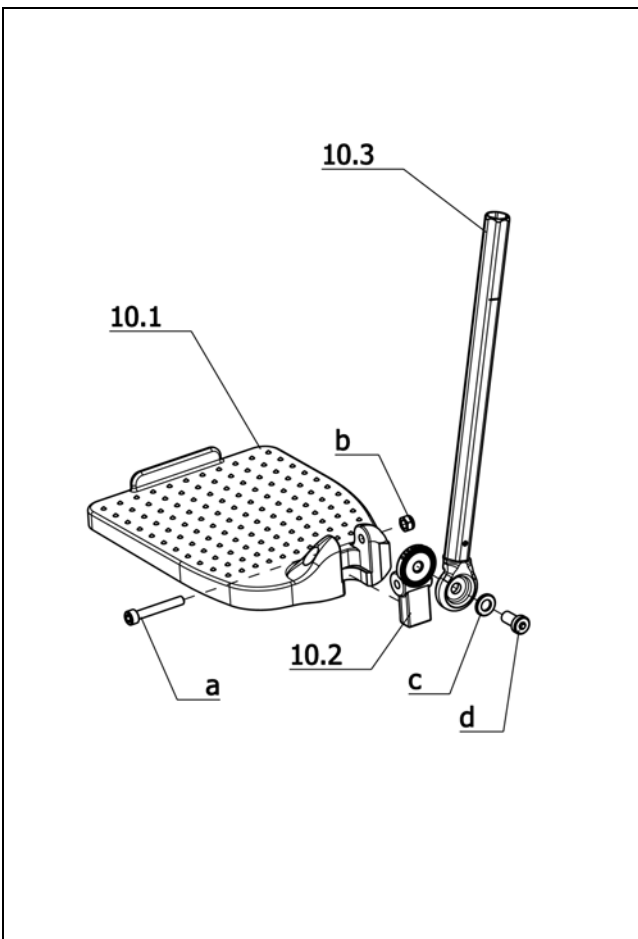

Sub Unit: Code 808; Foot plates angle adjustable

Item	Article-No:	Pc	Description
-	1 073 505	1	Lower leg supports Code 122-798/808 - 1 pair
10	1 073 507	1	Footboard left asmb. Code 122-798/808
10a	1 073 506	1	Footboard right asmb. Code 122-798/808
10.1	1 053 031	1	Footboard left for Code 43/45/46/48-805
10.1a	1 053 029	1	Footboard right for Code 43/45/46/48-805
10.2	1 058 918	2	Toothed insert
10.3	1 059 465	2	Insert tube
a	207 302 200	2	Cheese head screw DIN 912 M6x40
b	207 320 100	2	Locknut,DIN 980/8,M6, A3T
c	207 330 300	2	Washer DIN 125 - B8,4 ST A3T
d	207 353 000	2	Cheese head screw M8 X 16 DIN984 8.8 A3T VC3

iChair XXL / a
Component unit: Leg supports

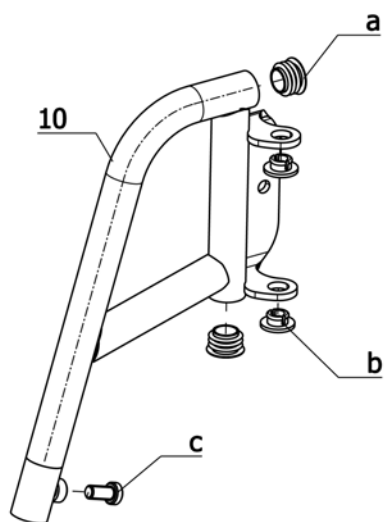

Sub Unit: Code 93; Removable leg supports, swivell-away

Item	Article-No:	Pc	Description
-	1 044 623	1	Leg support, assembled complete, Code 93
10	1 044 621	1	Leg support tube, left assembled
10a	1 044 622	1	Leg support tube, right assembled
a	205 047 400	2	Round plug 22, 22x1,5 SFL
b	205 009 806	2	Hinge bush, black, RAL 9005
c	207 353 000	2	Cheese head screw M8 X 16 DIN7984 8.8 A3T VC3
-	1 065 622	1	Leg strap for Code 93-345 (SW51)

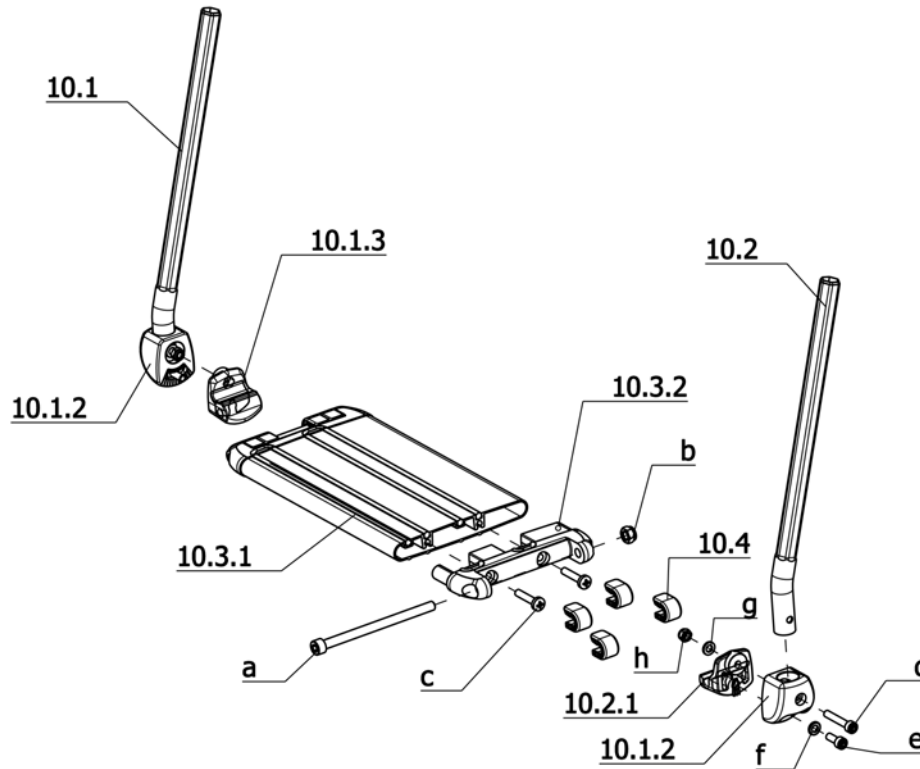

Sub Unit: Code 54; Footboard continuous (hexagon tube)

Item	Article-No:	Pc	Description
10.1	1 073 523	1	Insert tube right asmb
10.2	1 073 522	1	Insert tube left assy
10.1.2	1 049 691	2	Mount
10.1.3	1 047 996	1	Joint piece
10.2.1	1 047 997	1	Joint piece
10.3.1	1 049 639	1	Rubber buffer
10.3.2	1 048 906	2	End piece
10.4	1 047 998	8	Adjustment facility,assembled
a	207 352 900	2	Cheese head screw
b	207 320 200	2	Locknut DIN 985 M8-8 A3T
c	207 602 700	4	Tapping screw DIN 7516 M6x30
d	207 302 100	2	Cheese head screw, DIN 912 M 6x35-8.8
e	207 301 700	2	Cheese head screw,DIN 912, M 6x16-8.8
f	207 330 200	2	Washer,DIN 125-B6,4 St. A3T
g	207 023 700	2	Washer DIN 125-B 6,4 PVC
h	207 320 100	2	Locknut,DIN 980/8,M6, A3T

Sub Unit: Code 54; Footboard continuous (hexagon tube)

Item	Article-No:	Pc	Description
			Attention! State the corresponding colour code when ordering lower part of legrests, respectively foot boards.
			Code 48; Seat width 48cm
10	1 073 510	1	Lower leg support asmb. Code 48-54-93-128
10.3	1 071 425	1	Footboard asmb.
			Code 53; Seat width 53cm
10	1 073 511	1	Lower leg support asmb. Code 53-54-93-128
10.3	1 071 426	1	Footboard asmb.
			Code 358; Seat width 58 cm
10	1 073 512	1	Lower leg support asmb. Code 358-54-93-128
10.3	1 073 520	1	Footboard asmb.

iChair XXL / a
Component unit: Leg supports

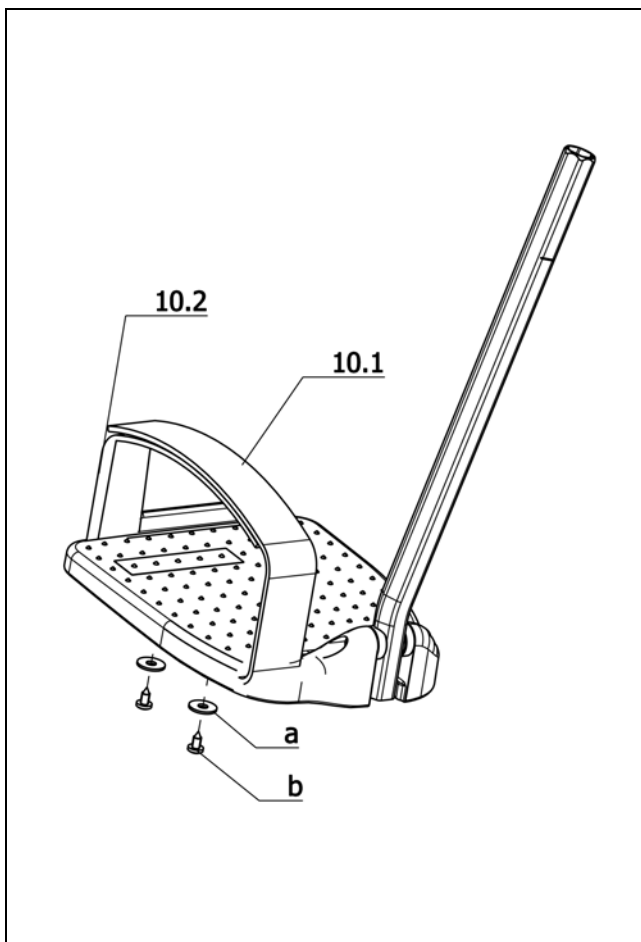

Sub Unit: Code 822; Shoe fastening strap

Item	Article-No:	Pc	Description
-	1 054 378	1	Shoe fastening strap Code 822 1 pair
10.1	1 012 444	2	Velcro fastener hook
10.2	1 012 445	2	Velcro fastener fleece
a	207 330 000	4	Washer DIN 9021 B 5.3
b	207 318 100	4	Filister head tapping screw, DIN 7981 B4,2x9,5 St.

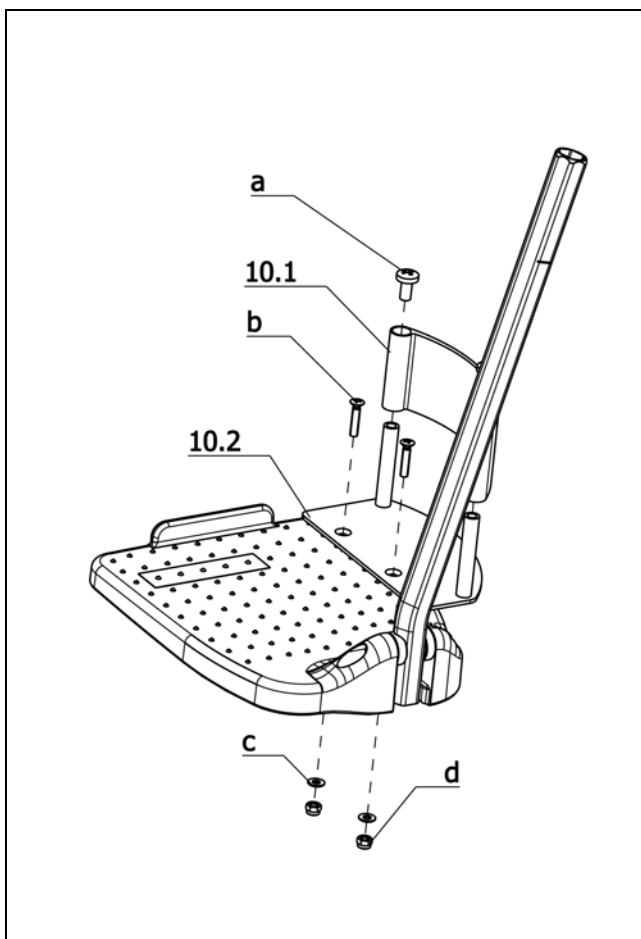

Sub Unit: Code 823; Heel support

Item	Article-No:	Pc	Description
-	1 012 396	1	Heel retainer Code 823
-	1 012 396	1	Heel retainer Code 823
10.1	1 012 384	2	Heel belt, Code 38/46-823
10.2	1 012 385	1	Sheet metal retainer, left Code 38/46-823
10.2a	1 012 386	1	Sheet metal retainer, right Code 38/46-823
a	207 340 600	4	Filister head screw DIN 7985 M 6x12-4.8
b	207 343 900	4	Countersunk head screw DIN 965 M4x16 8.8
c	207 330 800	4	Washer DIN 125 B 4,2
d	207 322 600	4	Locknut DIN 985 M 4

iChair XXL / a
Component unit: Electrical system

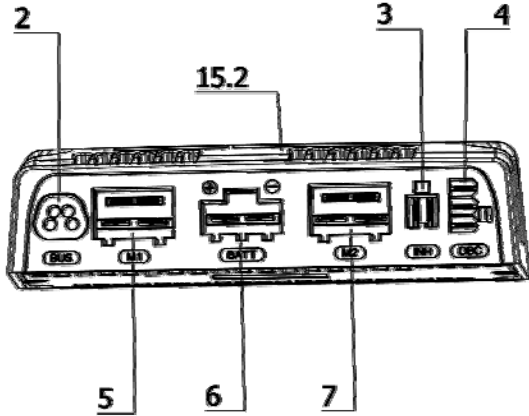

Sub Unit: Code 115-702; Speed 6km/h – Electronic R-Net

Item	Article-No:	Pc	Description
Contact allocation electronic (power module)			
2	0	0	BUS-cable
3	0	0	Inhibit 2
4	0	0	Inhibit 3
5	0	0	Driving motor left
6	0	0	Battery cable
7	0	0	Driving motor right
Code 115-702; Speed 6km/h – Electronic R-Net			
15.2	1 074 447	1	Electronic R-NET 120A Code 115-702
15.2	401 074 447	1	Exch.-electronic R-NET 120A Code 115-702
-	206 907 800	1	BUS-cable 1.2m (R-NET)
-	207 633 300	2	Countersunk head screw M5x25 DIN7991 8,8 A3K
-	207 330 100	2	Washer DIN 125-B5,3 St A3T
-	207 322 000	2	Locknut,DIN 980/8,M5
Code 27-115-702; Electric seat height adjustment – Speed 6km/h – Electronic R-Net			
15.2	1 074 909	1	Electronic R-NET 120A Code 27-115-702
15.2	401 074 909	1	Exch.-electronic R-NET 120A Code 27-115-702
-	206 922 700	1	BUS-cable 1.5m (R-NET)
-	207 019 100	2	Self tapping screw M5x30 DIN-EN-ISO-7085 ST A3T
-	207 330 100	2	Washer DIN 125-B5,3 St A3T

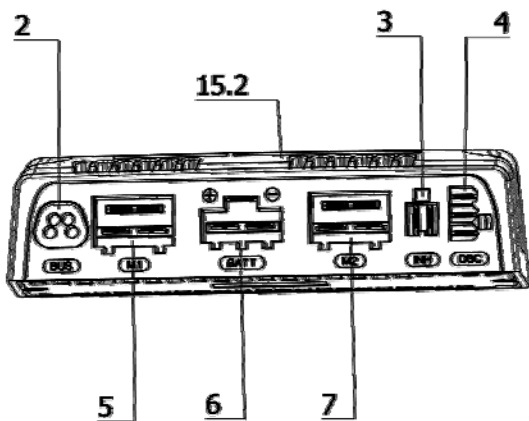

Sub Unit: Code 117-702; Speed 10km/h – Electronic R-Net

Item	Article-No:	Pc	Description
Contact allocation electronic (power module)			
2	0	0	BUS-cable
3	0	0	Inhibit 2
4	0	0	Inhibit 3
5	0	0	Driving motor left
6	0	0	Battery cable
7	0	0	Driving motor right
Code 117-702; Speed 10km/h – Electronic R-Net			
15.2	1 074 445	1	Electronic R-NET 120A Code 117-702
15.2	401 074 445	1	Exch.-electronic R-NET 120A Code 117-702
-	206 907 800	1	BUS-cable 1.2m (R-NET)
-	207 633 300	2	Countersunk head screw M5x25 DIN7991 8,8 A3K
-	207 330 100	2	Washer DIN 125-B5,3 St A3T
-	207 322 000	2	Locknut,DIN 980/8,M5
Code 27-117-702; Electric seat height adjustment – Speed 10km/h – Electronic R-Net			
15.2	1 074 911	1	Electronic R-NET 120A Code 27-117-702
15.2	401 074 911	1	Exch.-electronic R-NET 120A Code 27-117-702
-	206 922 700	1	BUS-cable 1.5m (R-NET)
-	207 019 100	2	Self tapping screw M5x30 DIN-EN-ISO-7085 ST A3T
-	207 330 100	2	Washer DIN 125-B5,3 St A3T

iChair XXL / a
Component unit: Electrical system

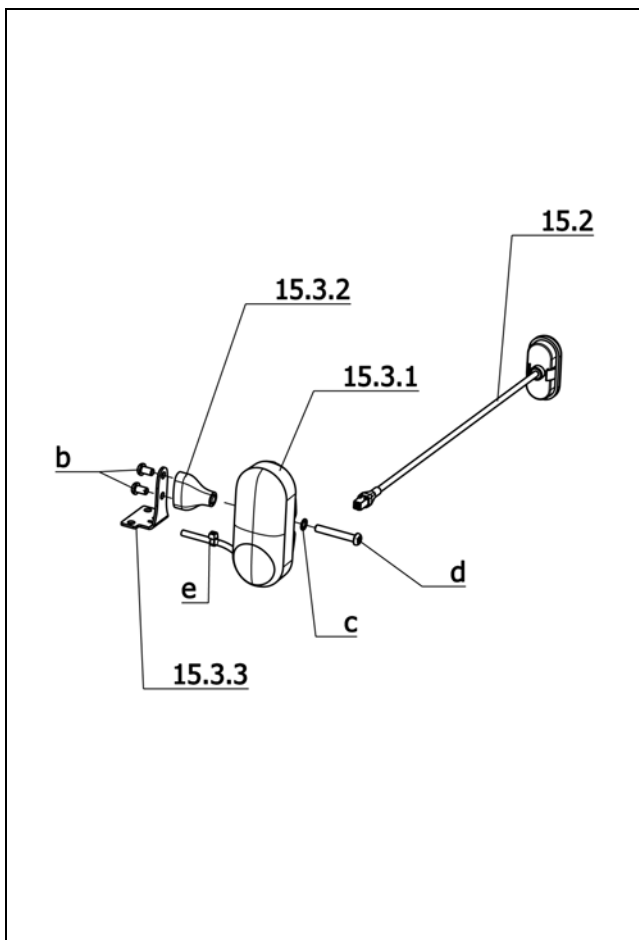

Sub Unit: Code 932; Lighting for electronic wheelchair

Item	Article-No:	Pc	Description
-	1 071 144	1	Lighting equipm. for R-NET (if req. order separately) ->view page adjustment-lighting module R-Net
15.2	1 070 510	2	Rear light (LED-technology)
15.3	1 070 514	1	Headlight/turn signal left asmb (LED-technology)
15.3a	1 070 515	1	Headlight/turn signal right asmb (LED-technology)
15.3.1	1 070 509	2	Headlight/turn signal w/o bracket (LED-technology)
15.3.2	1 069 954	2	Bracket for LED-front lighting
15.3.3	1 070 513	2	Angle plate
b	207 381 100	4	Filister head screw DIN 7380 M 6x10-10.9
c	207 429 700	2	Locking washer S6
d	207 380 300	2	Filister head screw, DIN 7380 M 6x40-10.9
e	206 954 200	2	CABLE BAND T 30 BLACK
-	1 071 146	1	Lighting cable left (Y-cable Code 702-932)
-	1 071 145	1	Lighting cable right (Y-cable Code 702-932)
Code 27; electric seat height adjustment			
-	1 071 158	1	Lighting equipm. for R-NET (if req. order separately) ->view page adjustment-lighting module R-Net

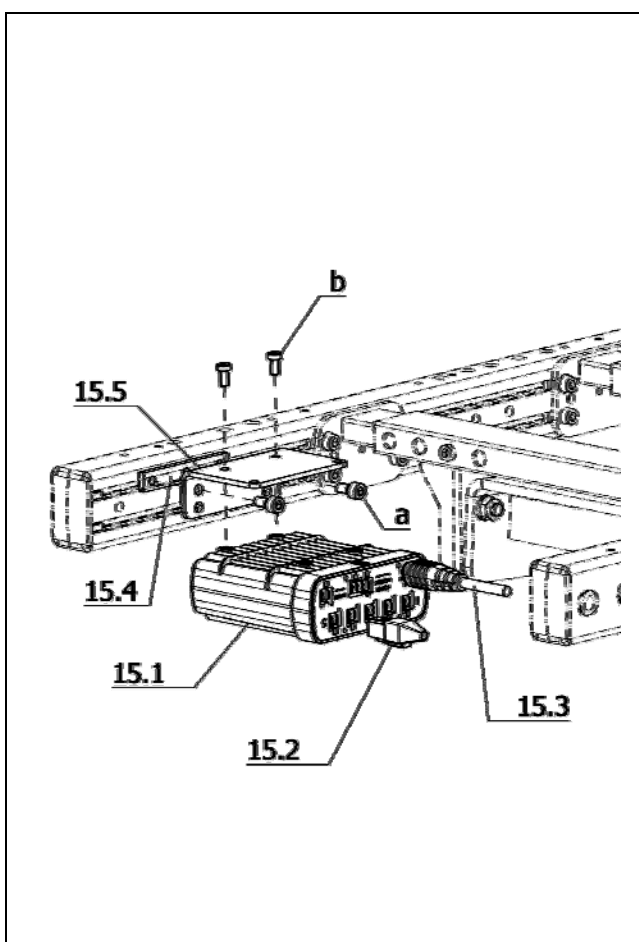

Sub Unit: Code 678-702-932; Adjustment-lighting module-R-Net

Item	Article-No:	Pc	Description
-	1 071 225	1	Adj.-lighting module (R-NET) w bridge and cable 1.2m
15.1	206 849 800	1	Adj.-lighting module (R-NET) w/o assembly parts
15.1	426 849 800	1	Exc. adj.-light. module(R-NET) w/o assembly parts
15.2	1 071 617	1	Bridge (f adj.-/light module R-NET)
15.3	206 907 800	1	BUS-cable 1.2m (R-NET)
15.4	1 069 799	1	Clamping piece 75x12x4 with 3x M6
15.5	1 071 222	1	Holding angle adjustment modul
a	207 122 300	2	Cheese head screw DIN 912 M6x12 -8.8
b	207 351 400	2	Cylinder screw M 5 x 10 DIN7984 8.8 A3T

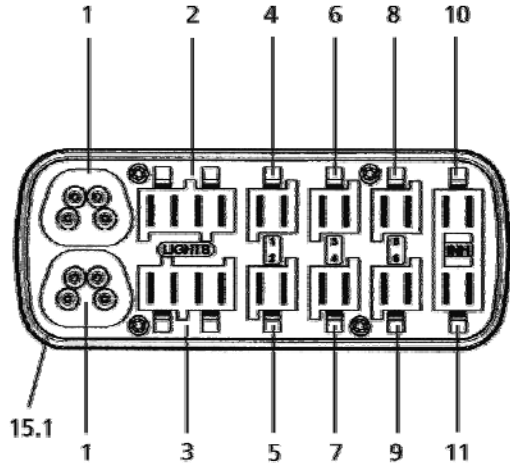

Sub Unit: Contact allocation adjustment module

Item	Article-No:	Pc	Description
15.1	206 849 800	1	Adj.-lighting module (R-NET) w/o assembly parts
1		0	2 BUS-cable
2		0	1 Lighting left
3		0	1 Lighting right
4		0	1 electr. adjustable back support
5		0	1 electr. seat angling
6		0	1 electr. leg support left
7		0	1 electr. leg support right
8		0	1 Lifting cylinder
9		0	1 RECARO electric adjustment
10		0	1 Bridge or end switch speed reduction
11		0	1 Tilt switch

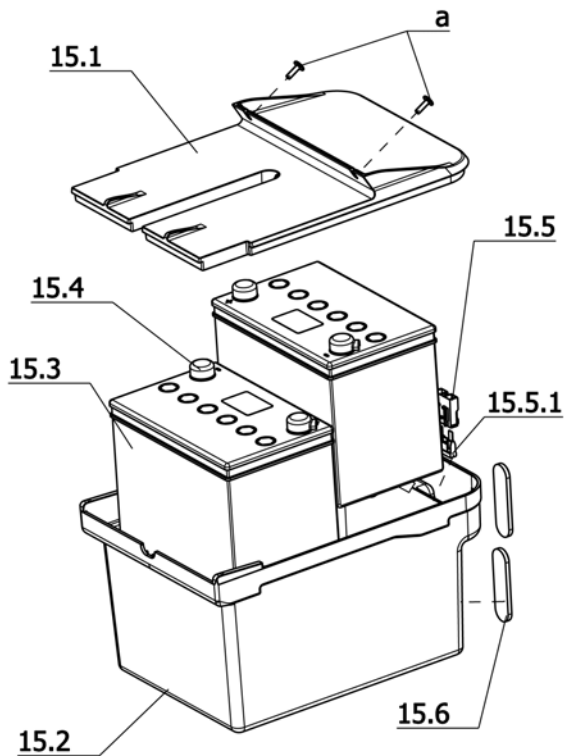

Sub Unit: Drive batteries, sealed ~ 63Ah-5h/73Ah-20h

Item	Article-No:	Pc	Description
15.1	1 069 763	1	Battery case - lid
15.2	1 069 760	1	Battery case - tub
15.3	206 864 700	2	Battery 12V 63Ah-5h/73Ah-20h sealed pole F-M6
15.4	1 070 526	4	Pole cap
15.5	1 057 824	1	Main Fuse ASMB.
15.5.1	206 847 800	1	Safety fuse / device, FK 3 80A
15.6	206 905 100	2	Reflector red 100x28mm oval
a	205 595 600	2	Flat head screw KF M6x16 4.8
-	1 070 505	1	Battery cable asmb
Chargers for sealed batteries			
-	205 572 800	1	Battery charger 24V/8A Code732 50-80Ah/20h (3 pole-NEUTRIK)
-	425 572 800	1	Exc. charger 24V/8A Code732 50-80Ah/20h (3 pole-NEUTRIK)
-	205 573 000	1	Battery charger24V/12A Code733 80-110Ah/20h (3-pole-Neutrik)
-	425 573 000	1	Exc. charger 24V/12A Code732 80-110Ah/20h (3-pole-Neutrik)
only for Great Britain			
-	205 572 900	1	Battery charger 24V/8A Code400 -732 50-80Ah/20h 3pole-NEUTRIK
-	425 572 900	1	Exc. charger 24V/8A C.400-732 50-80Ah/20h (3 pole-NEUTRIK)
-	205 573 100	1	Bat.charger24V/12A Code400-733 80-110Ah/20h (3-pole-Neutrik)
-	425 573 100	1	Exc. charger 24V/12A C.400-733 80-110Ah/20h (3-pole-Neutrik)

iChair XXL / a
Component unit: Working tables

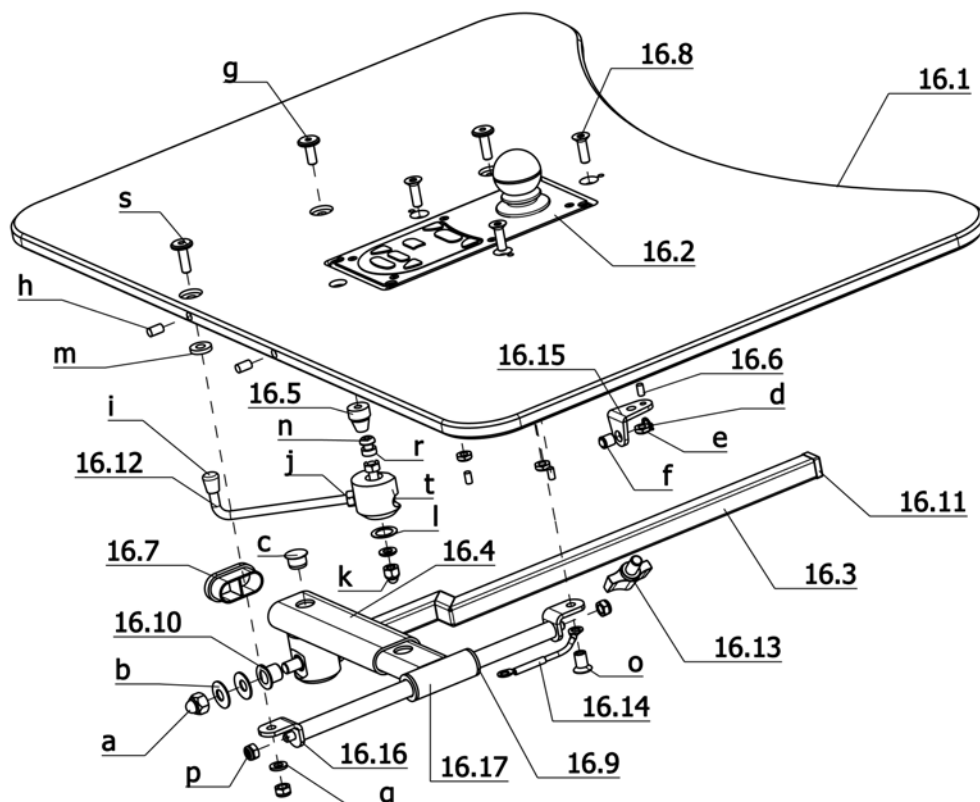

Sub Unit: Code 702-813; Electronic R-Net – Table top operation, swivelling

Item	Article-No:	Pc	Description
16.3	1 054 986	1	Pushing tube for Code 813/4646
16.4	1 072 460	1	Swivel tube
16.5	1 039 314	1	Locking bush
16.6	207 902 200	1	Cl-tol. gr. pin 4x8 ST 6.8 A2K
16.7	205 049 700	1	Plastic slide, 40 x 20 x 2
16.8	207 357 400	3	COUNTERSUNK SCREW DIN 7991 M6 X 20 8.8 A3T
16.9	1 056 454	2	Flange sleeve
16.10	206 554 700	2	Thrust bearing
16.11	205 006 000	1	Plastic slide, 15/15/1,5-2
16.12	1 072 676	1	Adjustment lever
16.13	205 112 800	1	KIPP clamping lever M8x35
16.14	1 072 917	1	Ground wire
16.15	1 054 539	1	Fixation angle
16.16	1 000 158	2	Support piece
16.17	1 039 317	1	Push tube
a	207 324 100	1	Locking cap nut DIN 986/5 M8 A3T
b	207 022 700	12	Cup spring, DIN 2093 20 x 8,2 x 1
c	205 047 000	1	Cover plug D: 13/16x8,5
d	207 330 400	1	Locking ring 8x0,8 DIN471
e	205 528 900	3	Spring stop hexagon nut,M6, NO.SSN.003
f	205 549 900	1	Pressure piece
g	205 595 600	1	Flat head screw KF M6x16 4.8
h	205 654 600	2	Magnet 6 x 10 mm
i	205 018 900	1	Plastic slide D/6
j	207 320 500	2	Hexagon nut 934-M6-5
k	207 320 000	1	Locking cap nut DIN 986 M6-8 A3T

Sub Unit: Code 702-813; Electronic R-Net – Table top operation, swivelling

Item	Article-No:	Pc	Description
l	207 029 600	1	Shim ring DIN 988 12x18x0,5 St
m	1 042 450	2	Type plate 25 x 80, red
n	207 380 900	1	Filister head screw ISO 7380 M6x45 10.9 A3T
o	205 596 100	1	Sleeve nut M6 black 9S20K
p	207 320 100	3	Locknut,DIN 980/8,M6, A3T
q	207 424 000	1	Washer DIN 125 B6,4 PVC black STK
r	1 027 449	1	Distance tube
s	205 596 400	2	Flat head screw M 6x20-4.8
t	1 054 988	1	Locking device
-	207 320 500	2	Hexagon nut 934-M6-5
-	207 330 200	1	Washer,DIN 125-B6,4 St. A3T
-	1 024 369	1	Clamping piece
-	1 039 318	1	Push bar
Code 60; Operation opposite to the standard version (left)			
16.2	1 072 900	1	Operating module asmb. Code 60-813 (R-NET)
-	1 072 919	1	Table-operated version asmb. Code 48/53-60-702-813
16.1	1 072 638	1	Therapy table plate 12x450x720 (for Code 813 w/o att. parts)
Code 74; Operation standard version (right)			
16.2	1 072 901	1	Operating module asmb. Code 74-813 (R-NET)
-	1 072 639	1	Table-operated version asmb. Code 48/53-74-702-813
16.1	1 072 638	1	Therapy table plate 12x450x720 (for Code 813 w/o att. parts)

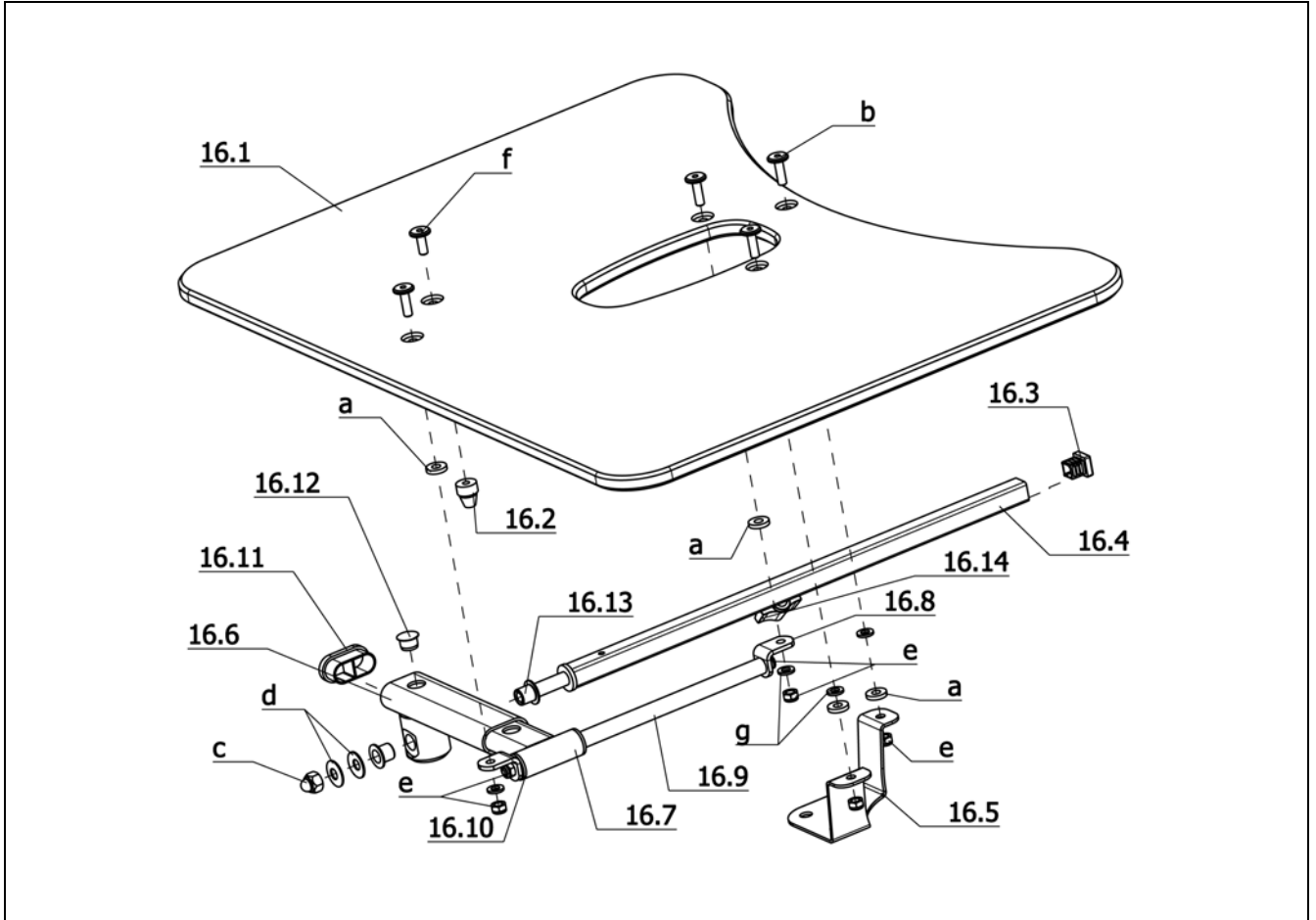

Sub Unit: Therapy table for tabletop operation

Item	Article-No:	Pc	Description
16.2	1 039 314	1	Locking bush
16.3	205 006 000	1	Plastic slide, 15/15/1,5-2
16.4	1 039 165	1	Push tube, complete
16.5	1 072 459	1	Holding angle incl. magnet
16.5.1	206 986 400	1	Permanent magnet
16.6	1 072 460	1	Swivel tube
16.7	1 039 317	1	Push tube
16.8	1 000 158	2	Support piece
16.9	1 039 318	1	Push bar
16.10	1 056 454	2	Flange sleeve
16.11	205 049 700	1	Plastic slide, 40 x 20 x 2
16.12	205 047 000	1	Cover plug D: 13/16x8,5
16.13	206 554 700	2	Thrust bearing
16.14	205 113 800	1	Wing screw M8x15
a	1 042 450	4	Type plate 25 x 80, red
b	205 596 400	4	Flat head screw M 6x20-4.8
c	207 324 100	1	Locking cap nut DIN 986/5 M8 A3T
d	207 022 700	2	Cup spring, DIN 2093 20 x 8,2 x 1
e	207 320 100	6	Locknut, DIN 980/8, M6, A3T
f	205 595 600	1	Flat head screw KF M6x16 4.8
g	207 424 000	4	Washer DIN 125 B6,4 PVC black STK
-	1 024 369	1	Clamping piece
-	207 350 200	1	Cheese head screw, M 6x12-8.8 A3T DIN6912
-	207 429 700	1	Locking washer S6

Sub Unit: Therapy table for tabletop operation

Item	Article-No:	Pc	Description
			Code 4661; Therapy plate for tabletop control left
-	1 072 447	1	Therapy table asmb. left Code 48/53-408/415-4661
-	1 072 455	1	Therapy table asmb. left Code 48/53-416-4661
16.1	1 070 839	1	Therapy table plate 12x400x720
			Code 4660; Therapy plate for tabletop control right
-	1 072 443	1	Therapy table asmb. right Code 48/53-408/415-4660
-	1 072 451	1	Therapy table asmb. right Code 48/53-416-4660
16.1	1 070 839	1	Therapy table plate 12x400x720

iChair XXL / a
Component unit: Working tables

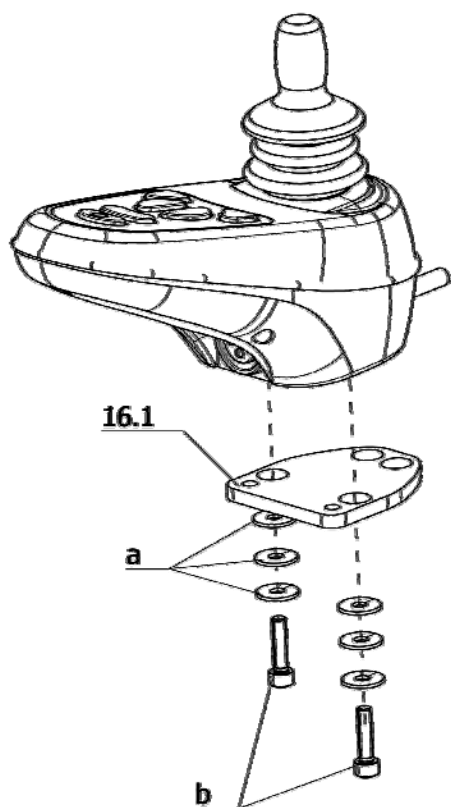

Sub Unit: Code 415; Control panel with LED display

Item	Article-No:	Pc	Description
16.1	1 070 767	1	Adapter plate
a	207 330 000	6	Washer DIN 9021 B 5.3
b	207 123 000	2	Cheese head screw, DIN 912 M5x20 8.8 A3K VC3 coated

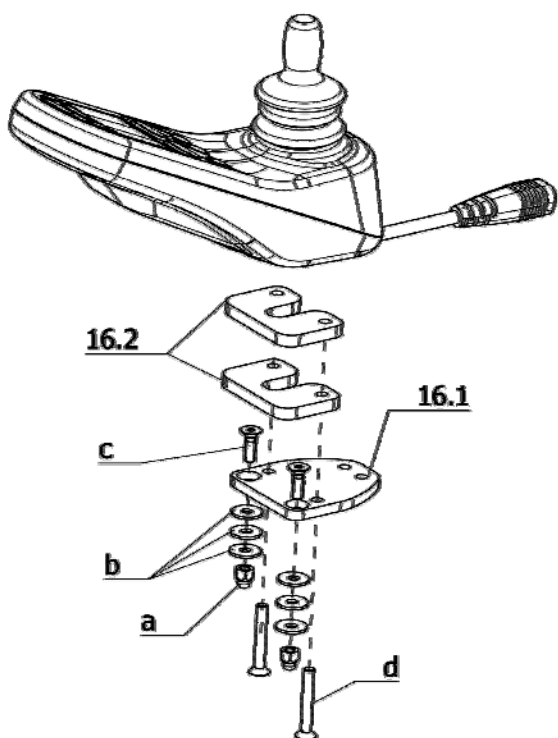

Sub Unit: Code 416; Control panel with LCD display

Item	Article-No:	Pc	Description
16.1	1 070 767	1	Adapter plate
16.2	1 070 768	2	Underliner 6mm
a	207 324 000	2	Locking cap nut, DIN 986, M5
b	207 330 000	6	Washer DIN 9021 B 5.3
c	207 633 400	2	Countersunk head screw DIN 7991 M6x16
d	207 200 900	2	Countersunk head screw, M5x30 DIN965

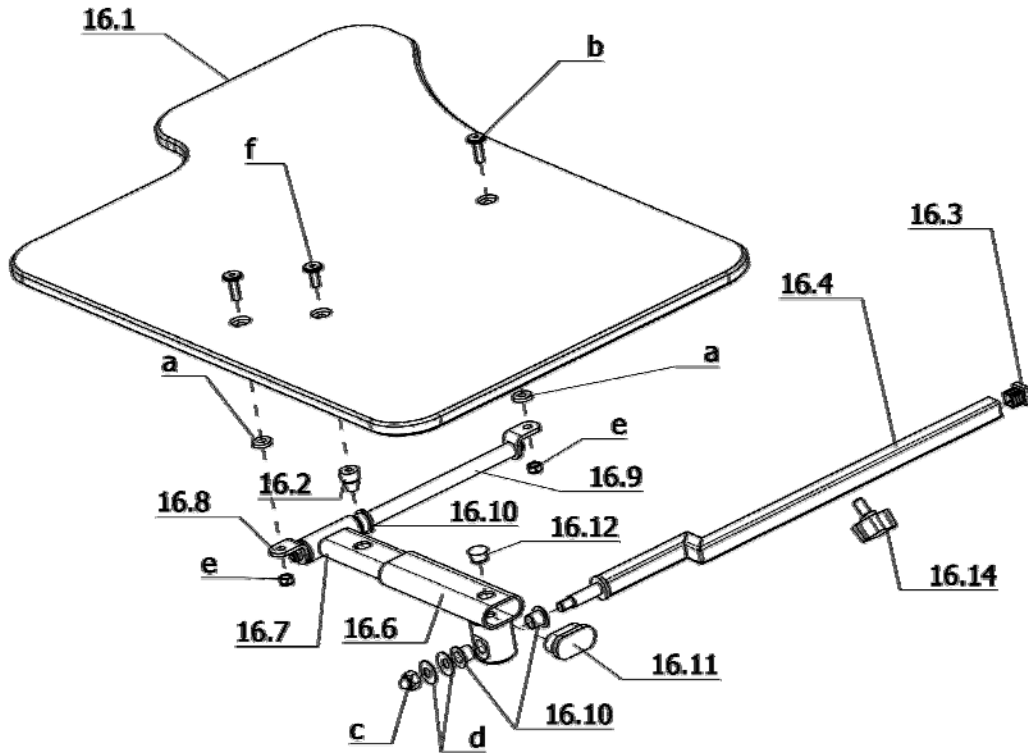

Sub Unit: Code 4646; Therapy table

Item	Article-No:	Pc	Description
16.2	1 039 314	1	Locking bush
16.3	205 006 000	1	Plastic slide, 15/15/1,5-2
16.4	1 054 986	1	Pushing tube for Code 813/4646
16.6	1 072 460	1	Swivel tube
16.7	1 039 317	1	Push tube
16.8	1 000 158	2	Support piece
16.9	1 039 318	1	Push bar
16.10	1 056 454	4	Flange sleeve
16.11	205 049 700	1	Plastic slide, 40 x 20 x 2
16.12	205 047 000	1	Cover plug D: 13/16x8,5
16.13	206 554 700	2	Thrust bearing
16.14	205 113 800	1	Wing screw M8x15
a	1 042 450	4	Type plate 25 x 80, red
b	205 596 400	4	Flat head screw M 6x20-4.8
c	207 324 100	1	Locking cap nut DIN 986/5 M8 A3T
d	207 022 700	2	Cup spring, DIN 2093 20 x 8,2 x 1
e	207 320 100	6	Locknut, DIN 980/8, M6, A3T
f	205 595 600	1	Flat head screw KF M6x16 4.8
-	207 424 000	2	Washer DIN 125 B6,4 PVC black STK
-	1 024 369	1	Clamping piece
-	207 350 200	1	Cheese head screw, M 6x12-8.8 A3T DIN6912
-	207 429 700	1	Locking washer S6

Sub Unit: Code 4646; Therapy table

Item	Article-No:	Pc	Description
			Seat width 48/53cm
-	1 072 626	1	Therapy table asmb. Code 48/53-4646 ->When ordering therapie tables please indicate operating module side (Code 60 or 74).
16.1	1 072 627	1	Therapy table plate 12x450x720

iChair XXL / a
Component unit: Other Codes

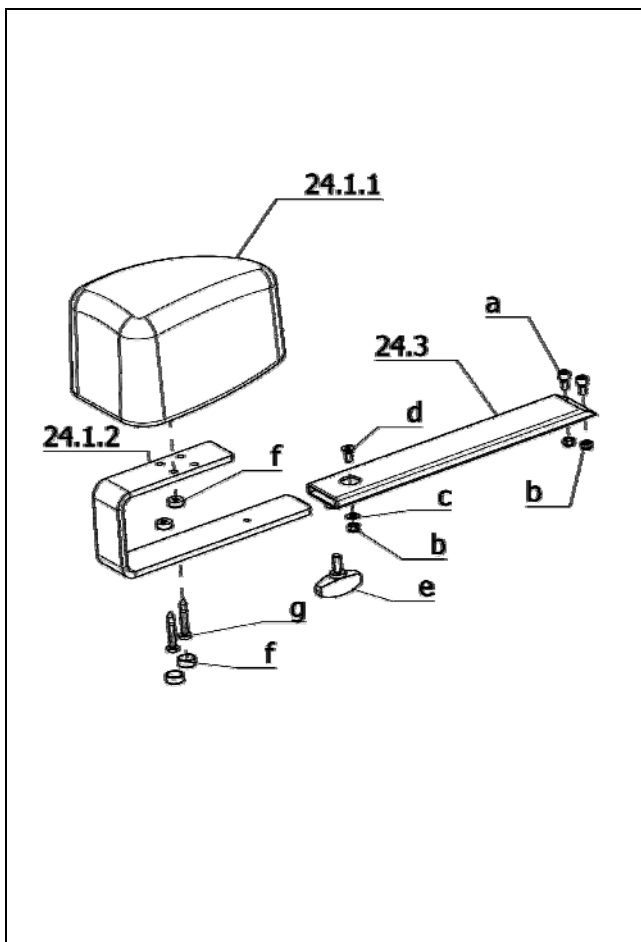

Sub Unit: Code 590; Adj. splay wedge

Item	Article-No:	Pc	Description
-	1 070 540	1	Splay wedge adjustable Code 590
24.1	1 049 421	1	Splay wedge pre-asmbl Code 590 (w/o telescopic tube)
24.1.1	1 048 179	1	Wedge
24.1.2	1 062 148	1	Adjustment rail
24.3	1 070 538	1	Telescopic tube
a	207 304 900	2	Cheese head screw, DIN 912
b	207 322 000	3	Locknut, DIN 980/8, M5
c	207 330 100	1	Washer DIN 125-B5,3 St A3T
d	207 355 300	1	Countersunk head screw DIN7991 M 5x12-8.8
e	205 114 800	1	WING SCREW M 6 X 15
f	8 396 457	2	KORREX-snap cap, black for cylinder screw M 5
g	207 145 300	2	Filister head tapping screw

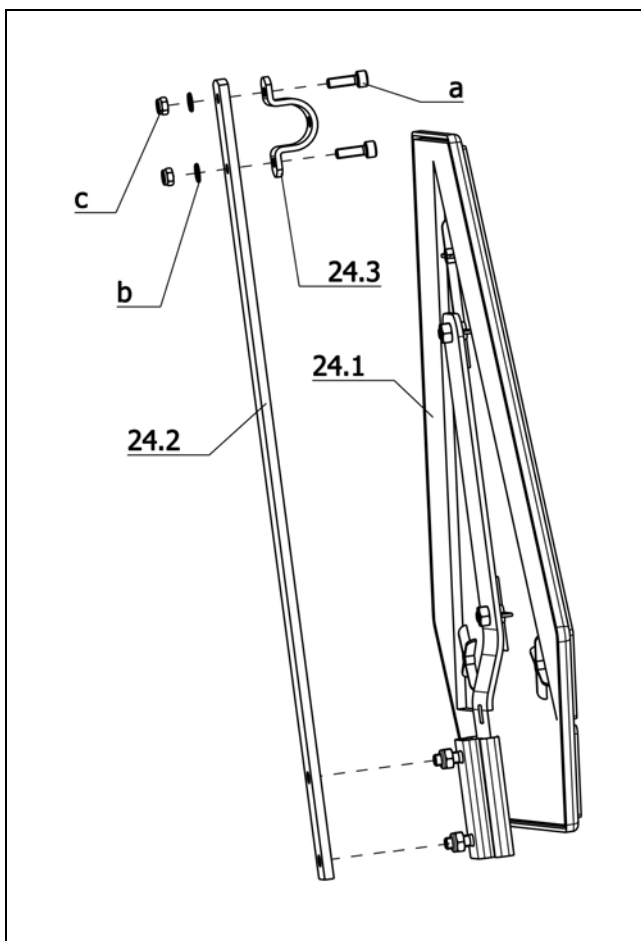

Sub Unit: Code 676; Rear marking plate

Item	Article-No:	Pc	Description
24	1 055 042	1	Warning sign asmb. Code 676 with bracket ->only for horizontal push bar Code 814
24.1	206 962 910	1	Rear marking plate Code 676 (w/o bracket f. E-wheelchairs)
24.2	1 055 043	1	Attachment rod for Code 676 Warning plate
24.3	1 054 578	1	Tube clamp
a	207 303 300	2	Cheese head screw DIN 912 M5x16
b	207 330 100	2	Washer DIN 125-B5,3 St A3T
c	207 322 000	2	Locknut, DIN 980/8, M5

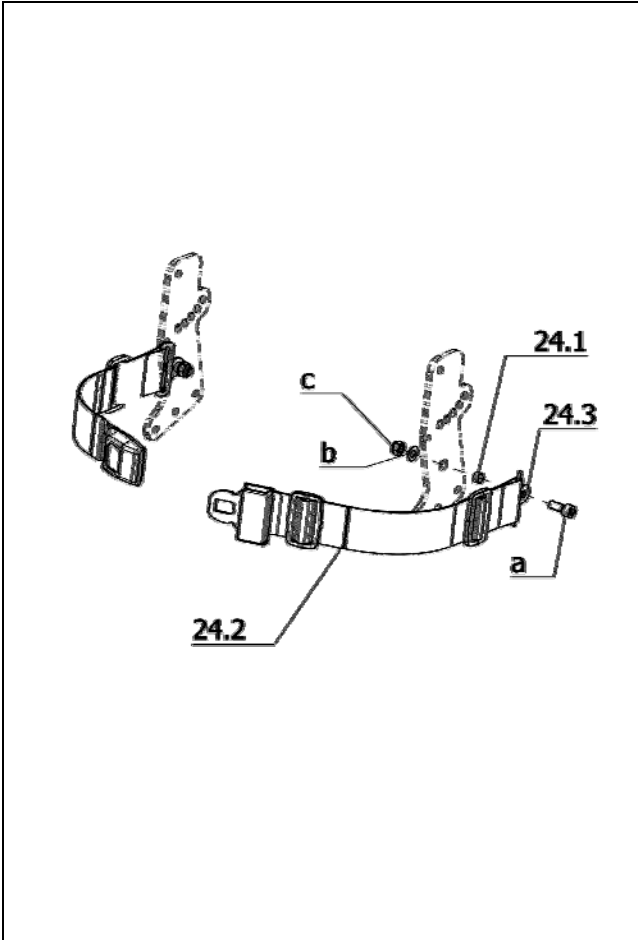

Sub Unit: Code 833; Safety belt

Item	Article-No:	Pc	Description
24	1 072 494	1	Retaining strap Code 803 Extra long with buckle
24.1	1 070 813	2	Socket "L=5.5 ;DA=11 ;DI=8.2mm"
24.3	8 103 914	2	Securing link Hip belt (retaining strap)
a	207 303 400	2	Cheese head screw DIN 912 M 8x20-8.8
b	207 330 300	2	Washer DIN 125 - B8,4 ST A3T
c	207 320 200	2	Locknut DIN 985 M8-8 A3T

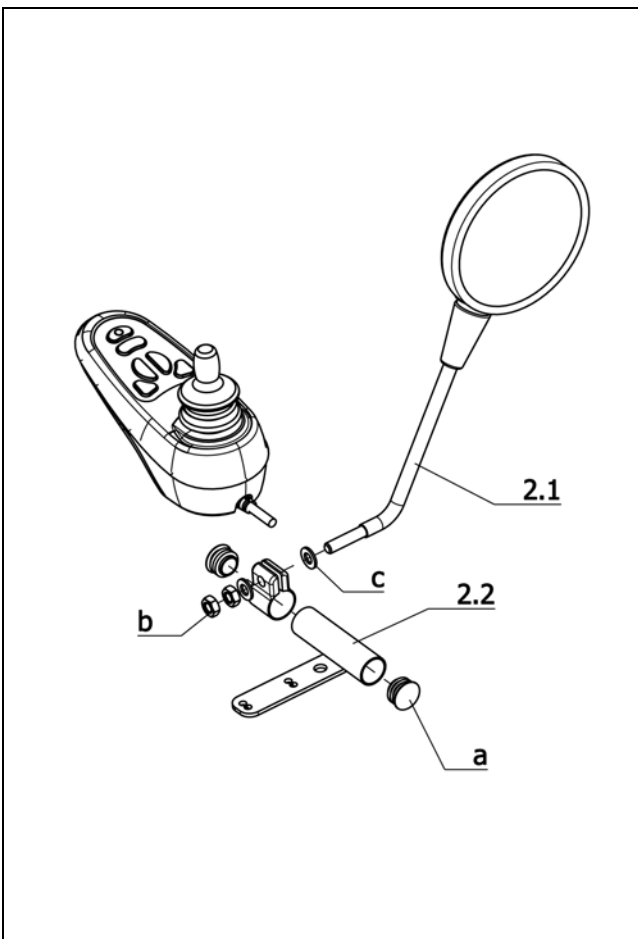

Sub Unit: Code 906; additional rearview mirror (right)

Item	Article-No:	Pc	Description
2	8 108 595	1	REARVIEWMIR. W BRACKET OM-SIDE F.VSI-ELECTRONIC CLOU/AVANTAGE
2.1	8 431 940	1	moped mirror No.:925/67 XPM
2.2	8 108 592	1	MIRROR BRACKET WELDED F.VSI-ELECTRONIC CLOU/AVANTAGE
a	205 047 400	2	Round plug 22, 22x1,5 SFL
b	207 316 600	2	HEXAGON SCREW M 5 X 22 8.8 A2R 8005876
c	207 429 300	2	Locking washer S5

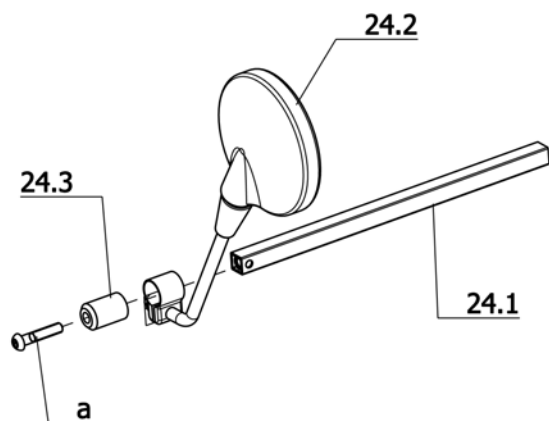
iChair XXL / a
Component unit: Other Codes

Sub Unit: Code 927; Rearview mirror

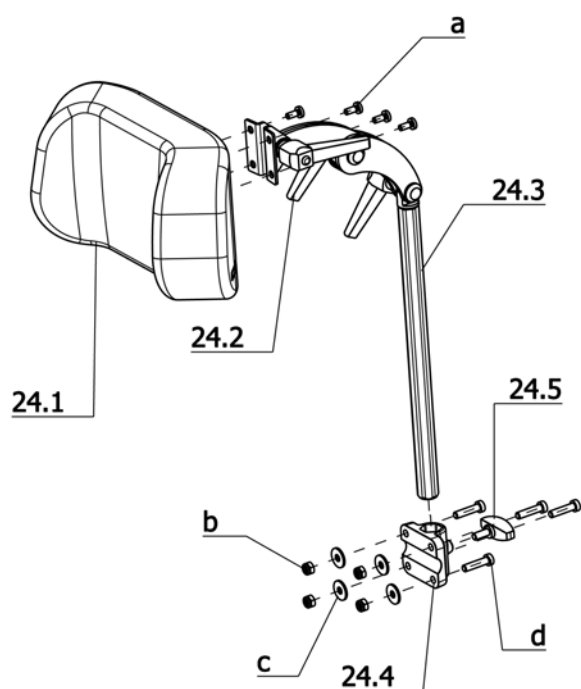
Item	Article-No:	Pc	Description
24	1 068 409	1	Rear-view mirror Code 4599 opposite to operating module
24.1	8 121 038	1	telescopic tube BG-Holder RONDO
24.2	8 431 940	1	moped mirror No.:925/67 XPM
24.3	8 134 064	1	holding pivot rearview mirror RONDO
a	207 381 000	1	Filister head screw ISO 7380 M8x40-10.9 A3T

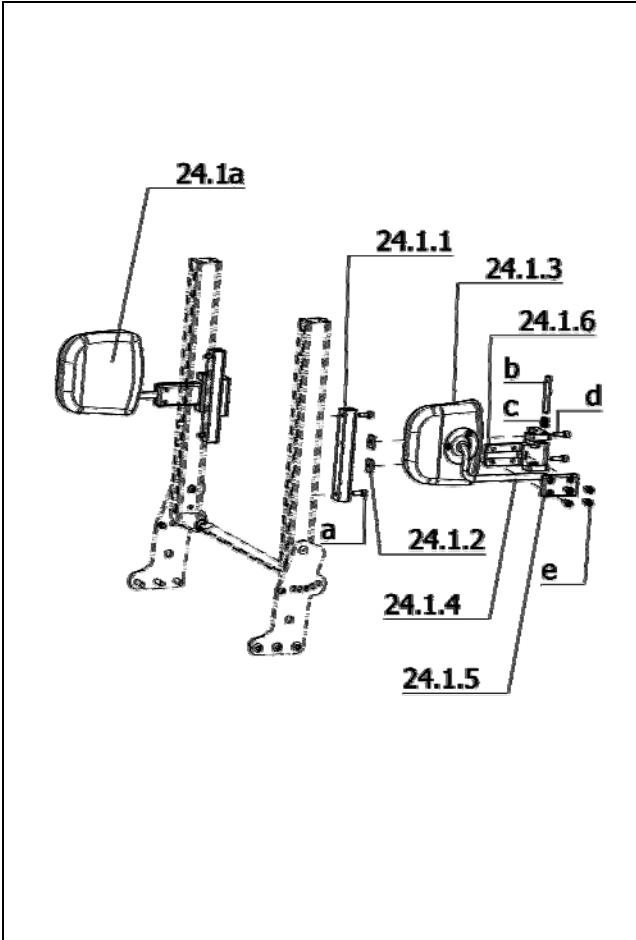

Sub Unit: Code 913-949-254; Head support removable – Back support anatomically formed – Synth. leather black

Item	Article-No:	Pc	Description
24	1 069 265	1	Head support asmb. Code 913-948-254
24.1	1 061 023	1	Head shell Code 254-913 (cushion asmb.)
24.2	8 460 133	3	Clamping lever adjustable GN503-63-M6-20SW black
24.3	1 059 670	1	Head support bracket cpl.
24.4	1 059 664	1	Head support bracket (incl. hex. socket receptacle)
24.5	205 114 800	1	WING SCREW M 6 X 15
a	207 301 300	4	Filister head screw DIN 7985- M5x12-4.8 A3K
b	207 320 100	4	Locknut, DIN 980/8, M6, A3T
c	207 335 100	4	Washer DIN 9021-B6,4 ST A3T
d	207 352 100	4	CYLINDER SCREW DIN 984 M 6 X 25 8.8 A3T
			Code 260; Memory function
-	1 076 042	1	Memory-function asmb. Code 260

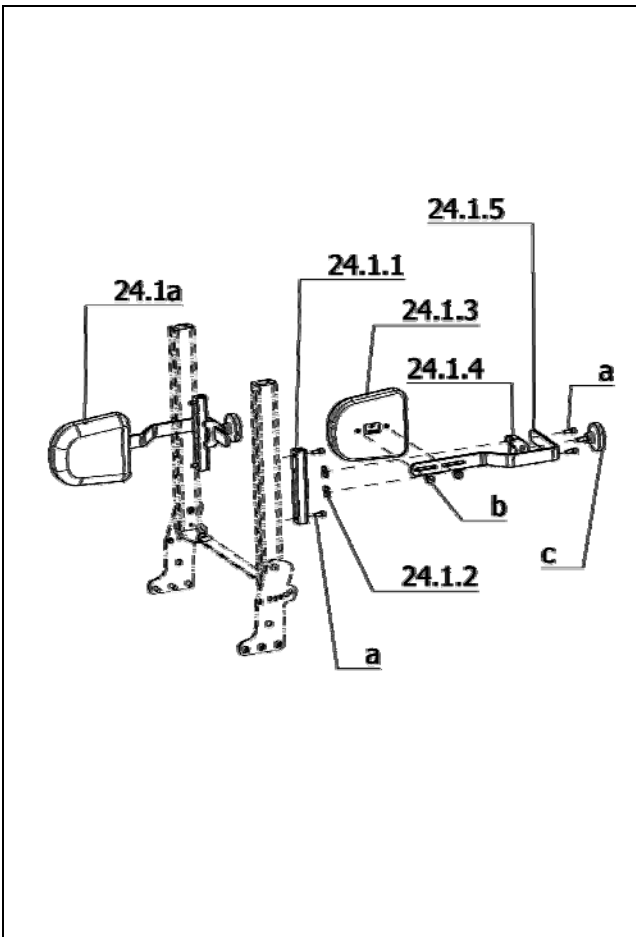

Sub Unit: Code 954; Torso supports, swivel-away

Item	Article-No:	Pc	Description
-	1 075 429	1	Torso support, swivel-away Code 954 - 1 pair
24.1	1 075 427	1	Torso support left asmb. swivel-away
24.1a	1 075 428	1	Torso support right cpl. swivel-away
24.1.1	1 075 419	2	Receptacle profile
24.1.2	1 002 850	4	Clamping piece
24.1.3	1 056 957	2	Pelotte (cushion)
24.1.4	1 075 425	2	Adjustment bracket left asmb.
24.1.4a	1 075 426	1	Adjustment bracket right asmb.
24.1.5	8 624 841	2	spanning plate ERGOPOR-side support
24.1.6	1 075 421	1	Joint piece left asmb.
24.1.6a	1 075 422	1	Joint piece right asmb.
a	207 301 700	4	Cheese head screw, DIN 912, M 6x16-8.8
b	207 440 500	2	Cylinder pin 8M6x60 ST A2K
c	8 010 900	2	PRESSURE SPRING 8.7X14.3X1.0 VPE 8338459
d	207 300 800	4	Cheese head screw, DIN 912 M 6x20-8.8
e	207 302 300	8	Cheese head screw, M6x12 DIN912 /8.8



Sub Unit: Code 957; Torso supports

Item	Article-No:	Pc	Description
-	1 075 432	1	Torso support fixed Code 957 - 1 pair
24.1	1 075 430	1	Torso support left asmb.
24.1a	1 075 431	1	Torso support right cpl.
24.1.1	1 075 419	2	Receptacle profile
24.1.2	1 002 850	4	Clamping piece
24.1.3	1 064 491	2	Side cushion L=160 W=140mm H=40mm
24.1.4	1 064 481	2	Side cushion profile (receptacle)
24.1.5	1 065 366	2	Side cushion bracket
a	207 301 700	8	Cheese head screw, DIN 912, M 6x16-8.8
b	205 595 600	4	Flat head screw KF M6x16 4.8
c	205 021 500	2	Handwheel with screw M8x20

iChair XXL / a
Component unit: Other Codes

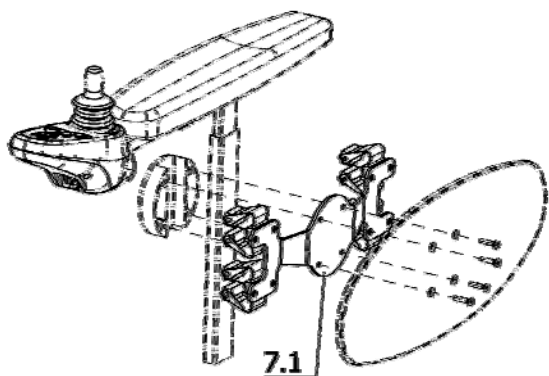

Sub Unit: Code 970; Walking stick holder

Item	Article-No:	Pc	Description
7.1	1 070 835	1	Walking aid holder Code 970

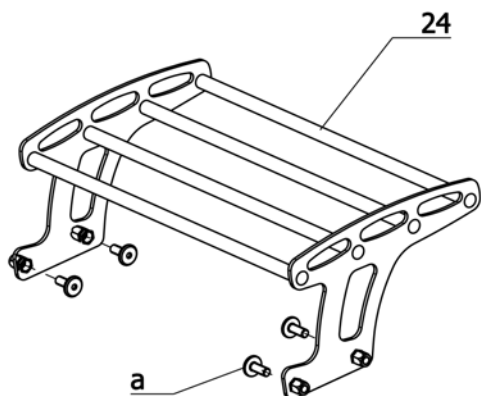

Sub Unit: Code 994, Baggage rack

Item	Article-No:	Pc	Description
-	1 069 787	1	Baggage rack asmb Code 994
24	1 069 786	1	Baggage rack
a	205 595 600	4	Flat head screw KF M6x16 4.8

Sub Unit: Accessories

Item	Article-No:	Pc	Description
			Code 565; Chin operation
-	1 074 111	1	Chin control asmb. (R-NET) Code 565, laterally swivelling
			Code 794; Bluetooth - Control
-	1 072 899	1	Bluetooth Control Code 794 (with R-NET elektronik)
			Code 810; Chin operation manually swivelling
-	1 072 890	1	Chin control asmb. (R-NET) Code 810, manual swivel-away
			Code 4571; Special control unit Omni PLUS
-	1 071 612	1	Oper. module OMNI + Code 4571 f spec. control incl. bracket
			Code 4904; Programming unit
-	1 071 611	1	Programming device DTT w adap. for R-NET/VR-2/S-DRIVE (set)
-	206 908 400	1	Adapter cable R-NET for Programming unit 206908300
-	206 908 600	1	Adapter cable VR-2 for Programming unit 206908300
-	206 908 800	1	Computer-program for R-NET
			Code 4565; Operating hour counter
-	1 072 431	1	Operating hour counter Code 4565
			Code 4795; Safety plug with pocket
-	8 106 011	1	DRIVING KEY DUO 2

Sub Unit: Accessories

Item	Article-No:	Pc	Description
			Code 4941; Flex bracket
			Code 60; Operation opposite to the standard version (left)
-	1 065 520	1	Flex 2 bracket right Code 60-4941
-	1 065 414	1	Receptacle tube cpl. ->The flex bracket is mounted on the right hand side when the operating module is mounted on the left side
			Code 74; Operation standard version (right)
-	1 064 399	1	Flex 2 bracket left Code 74-4941
-	1 065 423	1	Receptacle tube cpl. ->The flex bracket is mounted on the left hand side when the operating module is mounted on the right side

iChair XXL / a
Notes

iChair XXL / a
Notes



Your specialist dealer

MEYRA[®]
ORTOPEDIA
We move people.

MEYRA-ORTOPEDIA
Vertriebsgesellschaft mbH
Meyra-Ring 2 • D-32689 Kalletal-Kalldorf

B.P. 1703 • D-32591 Vlotho
Fon +49(0)5733 922-333
Fax +49(0)5733 922-9333
info@meyra.de • www.meyra.de
info@ortopedia.de • www.ortopedia.de

VIS III /Order-No.: 1 074 607 Status date: 2013-09 Subject to technical modifications